

U.S. MAIN BATTLE TANK

M1A1 TUSK

M1A2 SEP ABRAMS TUSK I/ M1A2 SEP ABRAMS TUSK II



RM-5004

The main instruction of this manual is for M1A2 SEP ABRAMS TUSK II. M1A2 SEP ABRAMS TUSK I and M1A1 TUSK are options. The **green lines** used for **M1A1 TUSK**, please read the instruction manual carefully before assembly.

本产品组装说明书主体型号为M1A2 SEP ABRAMS TUSK II，M1A2 SEP ABRAMS TUSK I 和M1A1 TUSK为选装，**M1A1 TUSK用绿色区分**，请在组装前仔细阅读说明书。



Assembly Icon



OPTIONAL
选择



CEMENT
膠水



DO NOT CEMENT
不使用膠水



INSTANT CEMENT
瞬間接著劑



BEND
彎折



MAKE 2pcs
製作2組



OPEN HOLE
鑽孔



CAT
切除



BE CAREFUL
注意



APPLY DECAL
貼上水貼紙



Read carefully and fully understand the instructions before commencing assembly. Supervising adult should also read the instructions if a child assembles the model. When you used glue or paint, do not use near a naked flame, and use in a well-ventilated room. When assembling this kit, tools including knives are used. Extra care should be taken to avoid personal injury. Read and follow the instructions supplied with paints and/ or cement. Use plastic cement and paints only. Keep out of reach of small children. Children must not be allowed to suck any part, or pull vinyl bag over the head.

在裝配前仔細閱讀說明並完全理解。小孩裝配時需成人看護且需仔細閱讀說明。
使用膠水和油漆時，應遠離火源並打開窗戶保持空氣流通。
製作時請格外注意工具刀和零件的鋒利尖銳部分，避免對身體造成傷害。
在使用膠水和油漆前仔細閱讀注意事項，按照說明正確使用膠水和油漆。
請將本品放在兒童接觸不到的地方，套件中的塑膠包裝袋會對兒童造成窒息的危險。

A x1

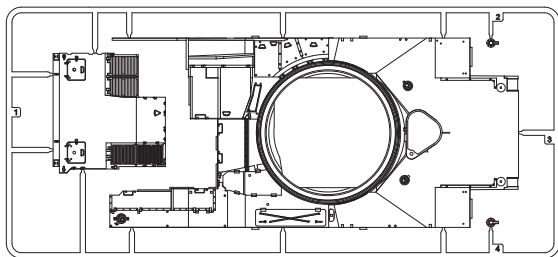

E x1

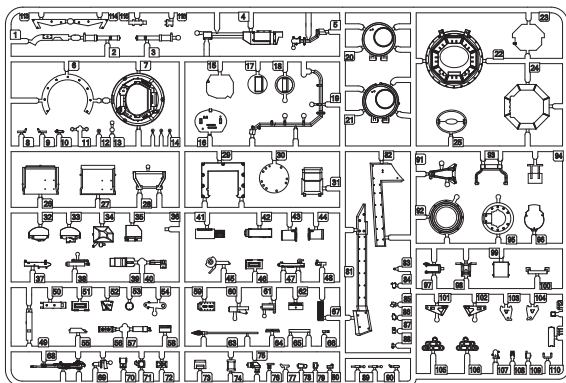

J x1

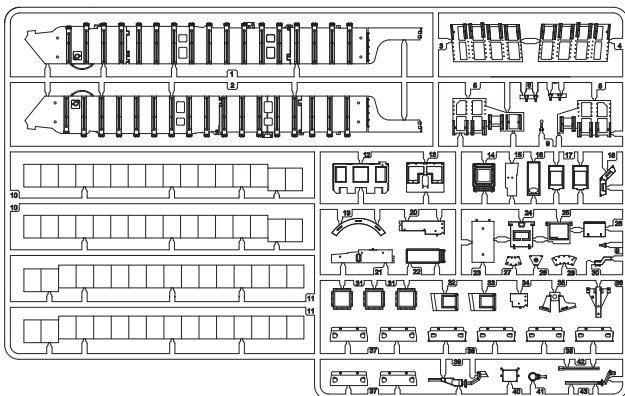

C x2

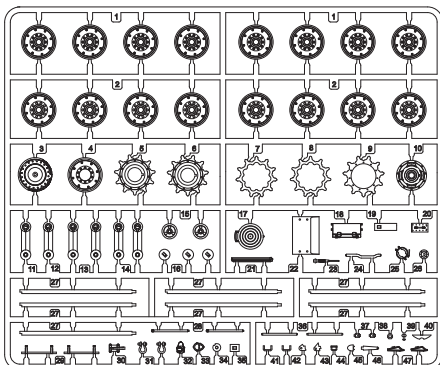

Lower Hull x1

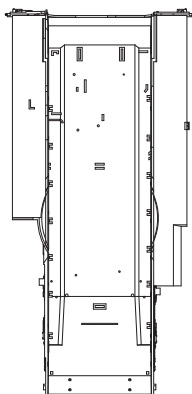

O x2

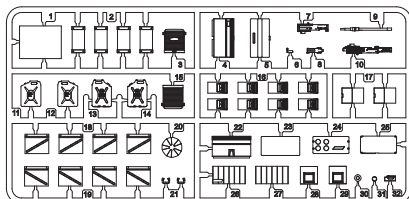

H x1

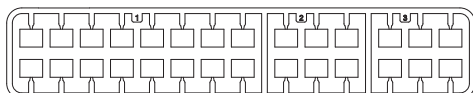

X x6

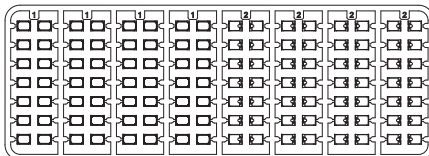

Y x5

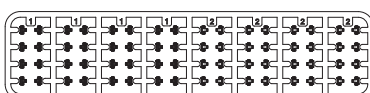

B x1

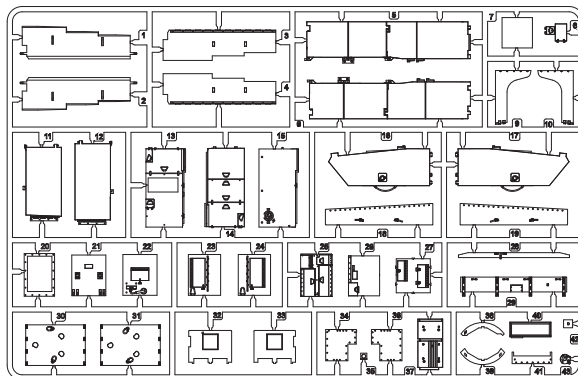

D x1

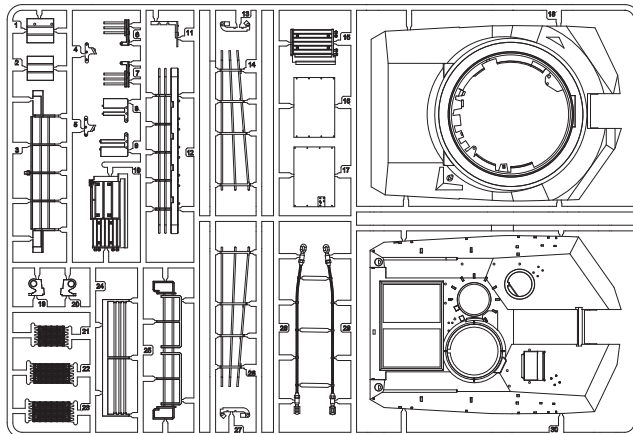

F x1

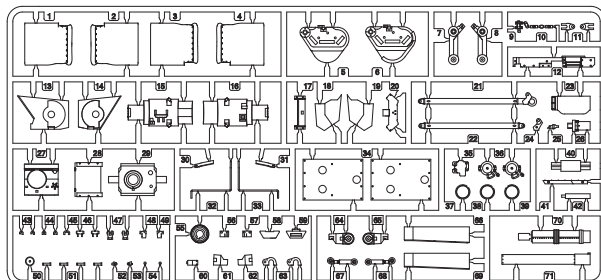

K x1

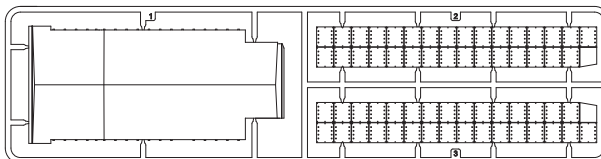

Tracks pins x 156



Assembly boards x 2



T x2

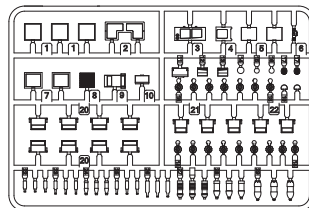

M x2

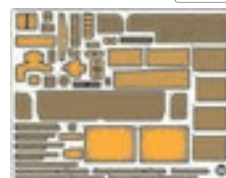

Decal x1

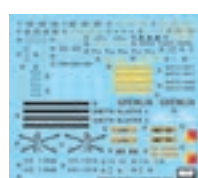



U.S. Main Battle Tank M1A2 SEP Abrams TUSK II

Painting and Marking Guide

Color info and profiles by



A.MIG 025 US Modern Vehicles	A.MIG 033 Rubber & Tires	A.MIG 035 Dark Tracks
A.MIG 045 Gun Metal	A.MIG 046 Matt Black	A.MIG 047 White
A.MIG 049 Red	A.MIG 084 NATO Green	A.MIG 086 Blue (RAL 5019)

1st Battalion, 22nd Infantry Regiment, 1st Brigade, 4th Infantry Division, Baghdad, July 2008

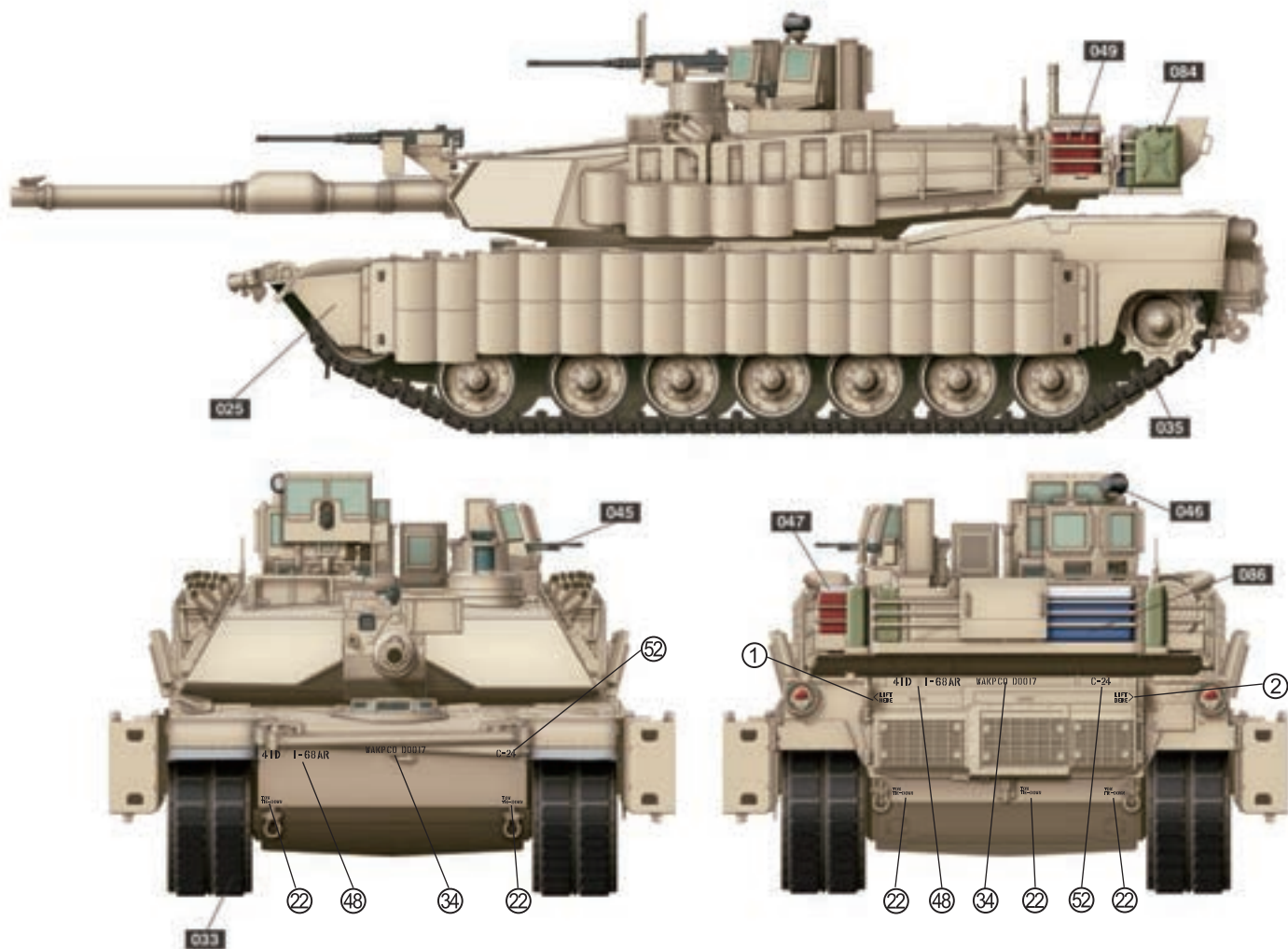



U.S. Main Battle Tank M1A2 SEP Abrams TUSK I

Painting and Marking Guide

Color info and profiles by



AMIG 025 US Modern Vehicles	AMIG 033 Rubber & Tires	AMIG 035 Dark Tracks
AMIG 045 Gun Metal	AMIG 046 Matt Black	AMIG 047 White
AMIG 049 Red	AMIG 084 NATO Green	AMIG 086 Blue (RAL 5019)

68th Armored Regiment, 1st Brigade, 4th Infantry Division, Iraq

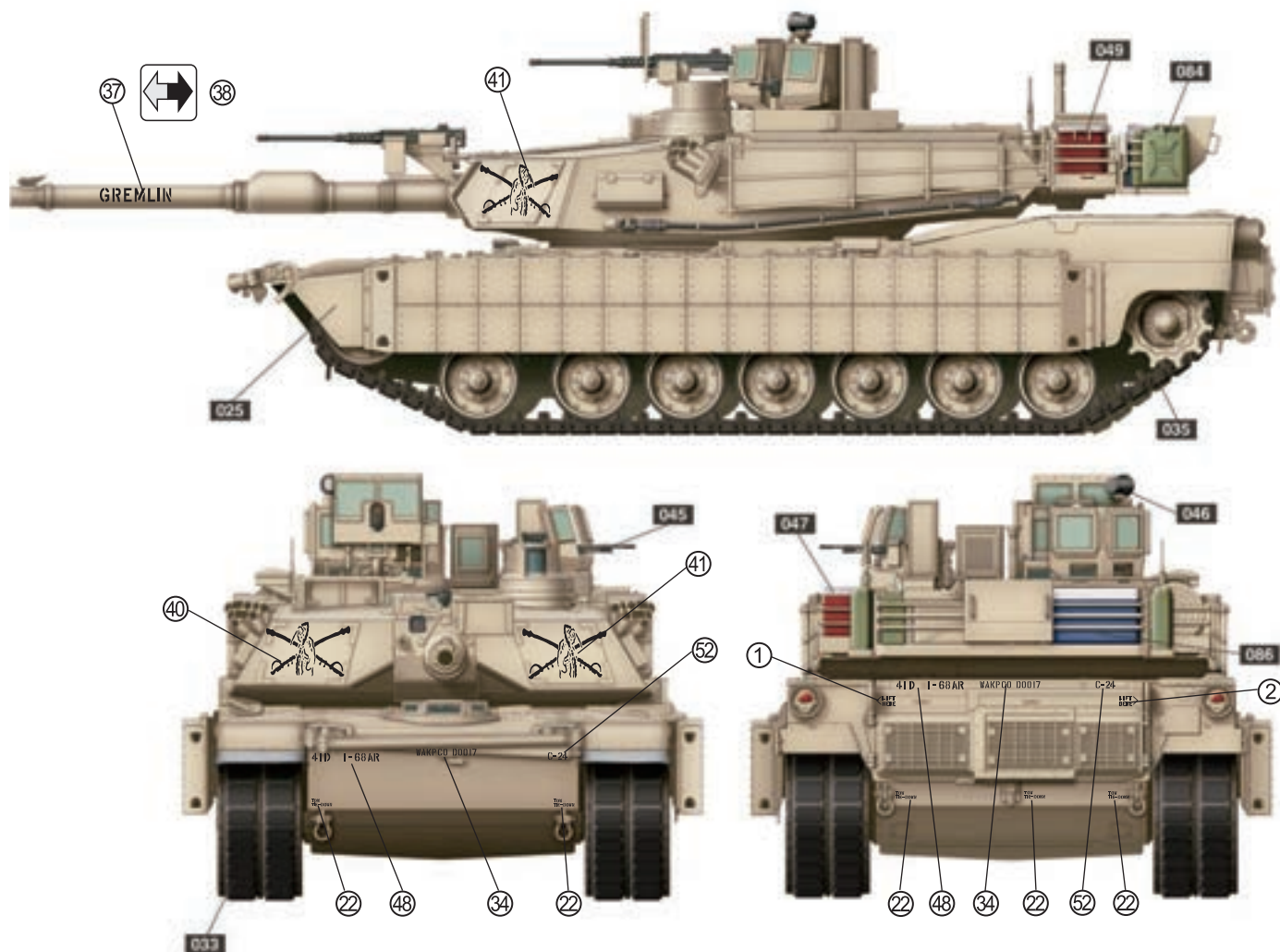



U.S. Main Battle Tank M1A1 TUSK

Painting and Marking Guide

Color info and profiles by



AMG 025 US Modern Vehicles	AMG 033 Rubber & Tires	AMG 035 Dark Tracks
AMG 045 Gun Metal	AMG 046 Matt Black	AMG 047 White
AMG 049 Red	AMG 084 NATO Green	AMG 085 NATO Brown
AMG 086 Blue (RAL 5019)		

1st Battalion, 35th Armor Regiment

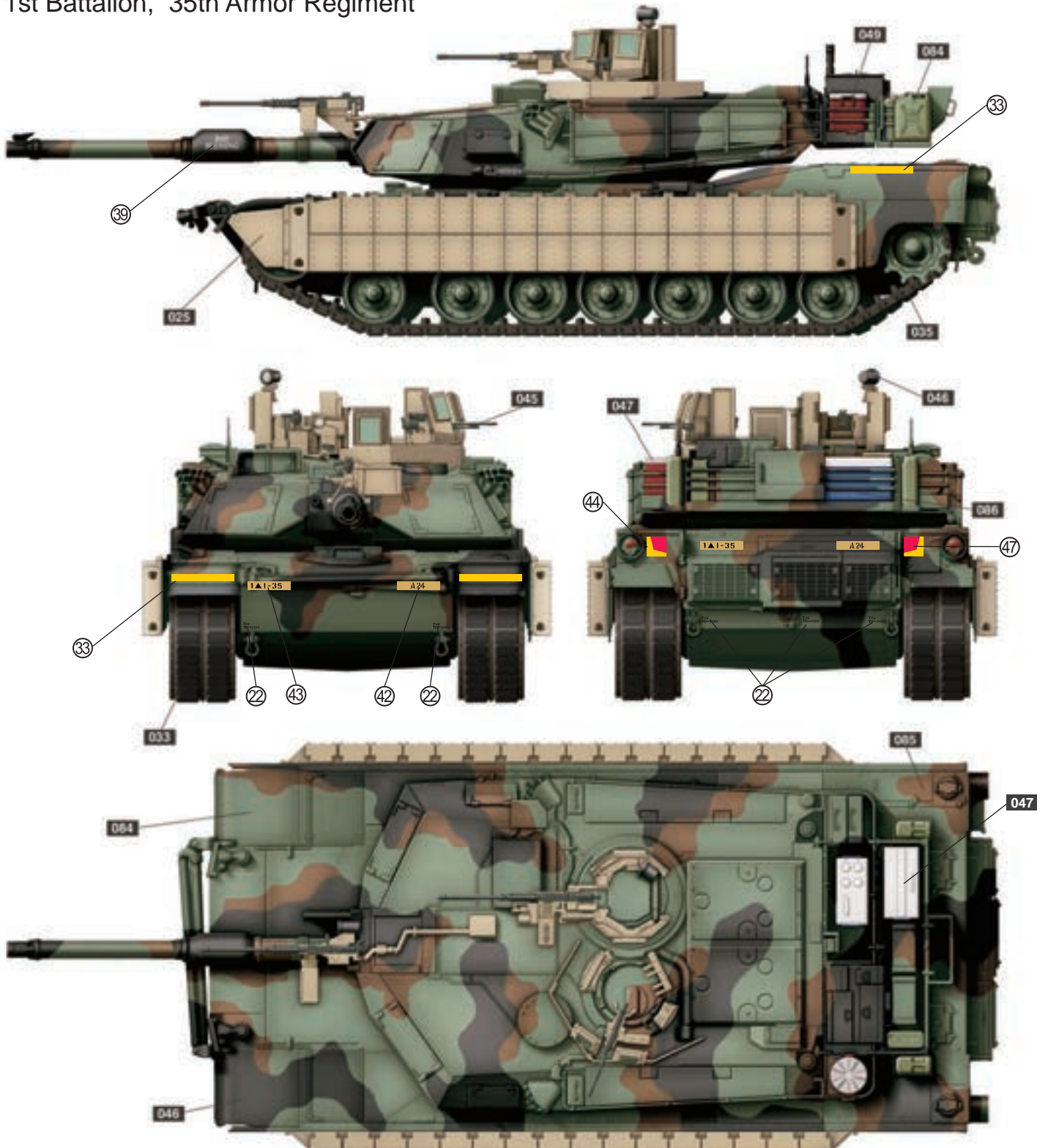

A

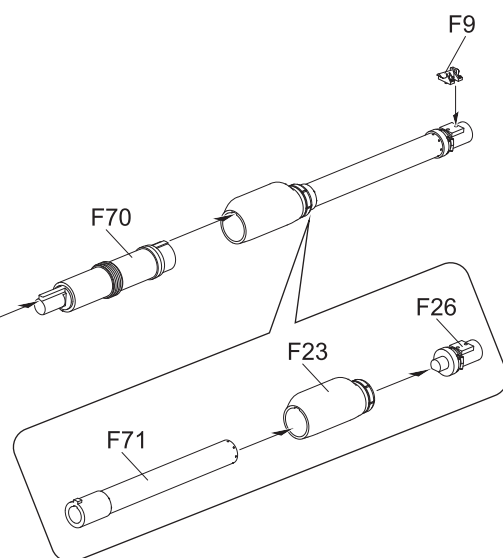
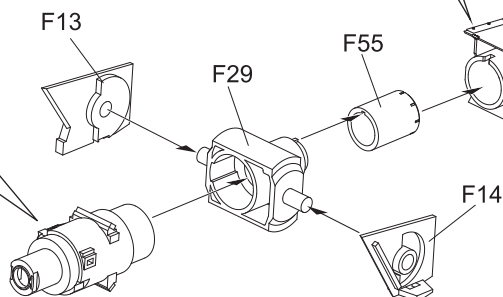
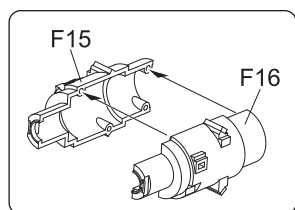
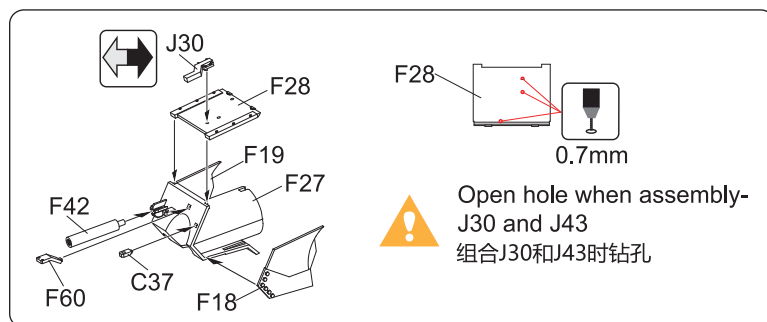

A-1

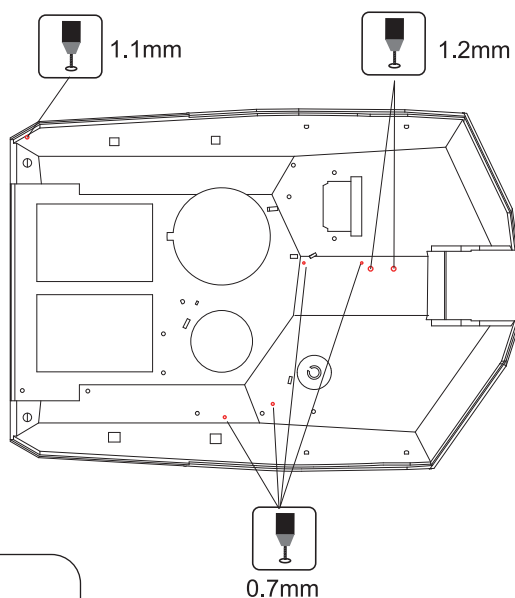
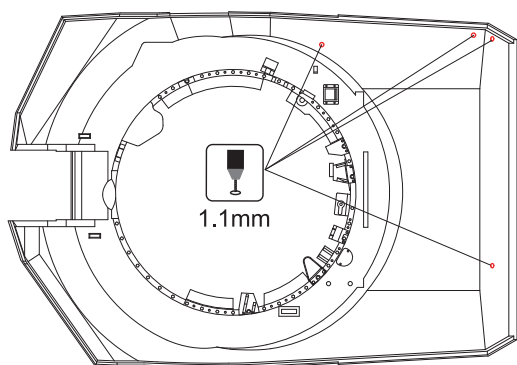

Cut when assembly
M1A2 TUSK II
组合M1A2 TUSK II时切除

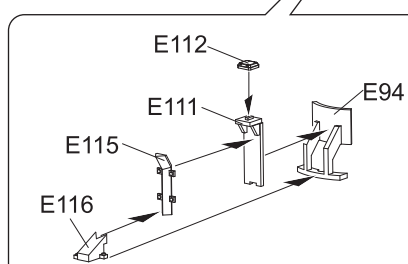
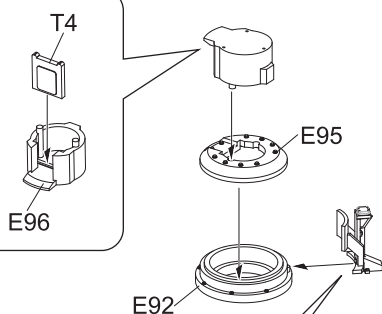
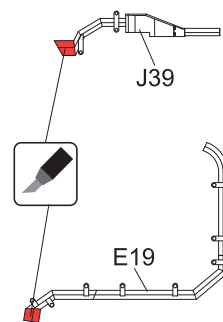

A-2

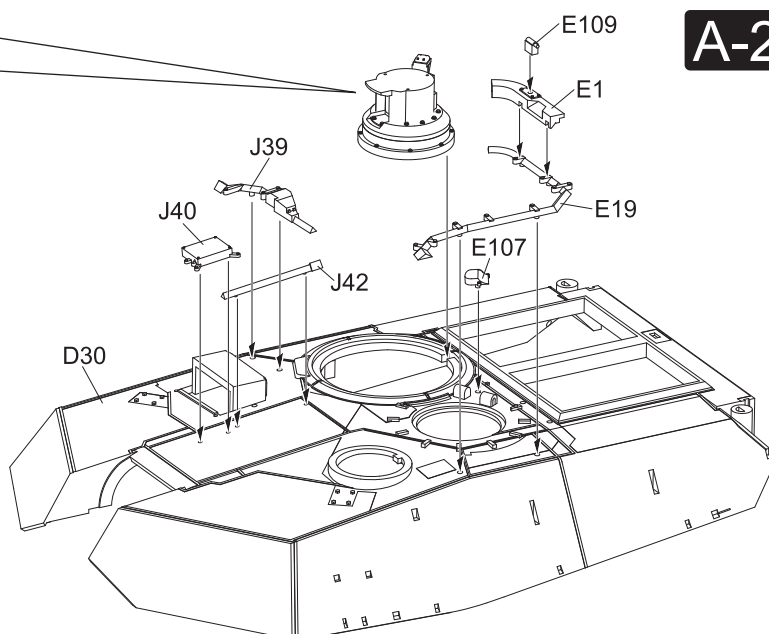

A-3

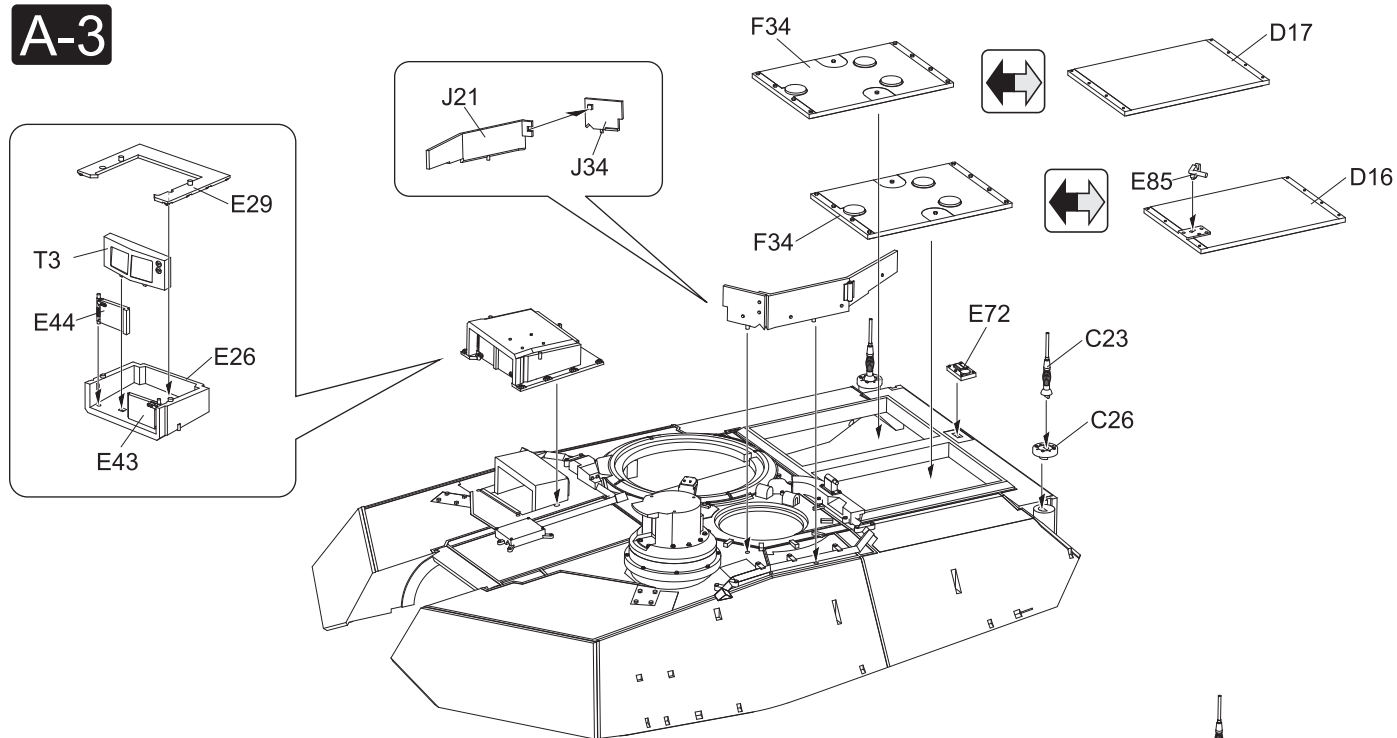

A-4

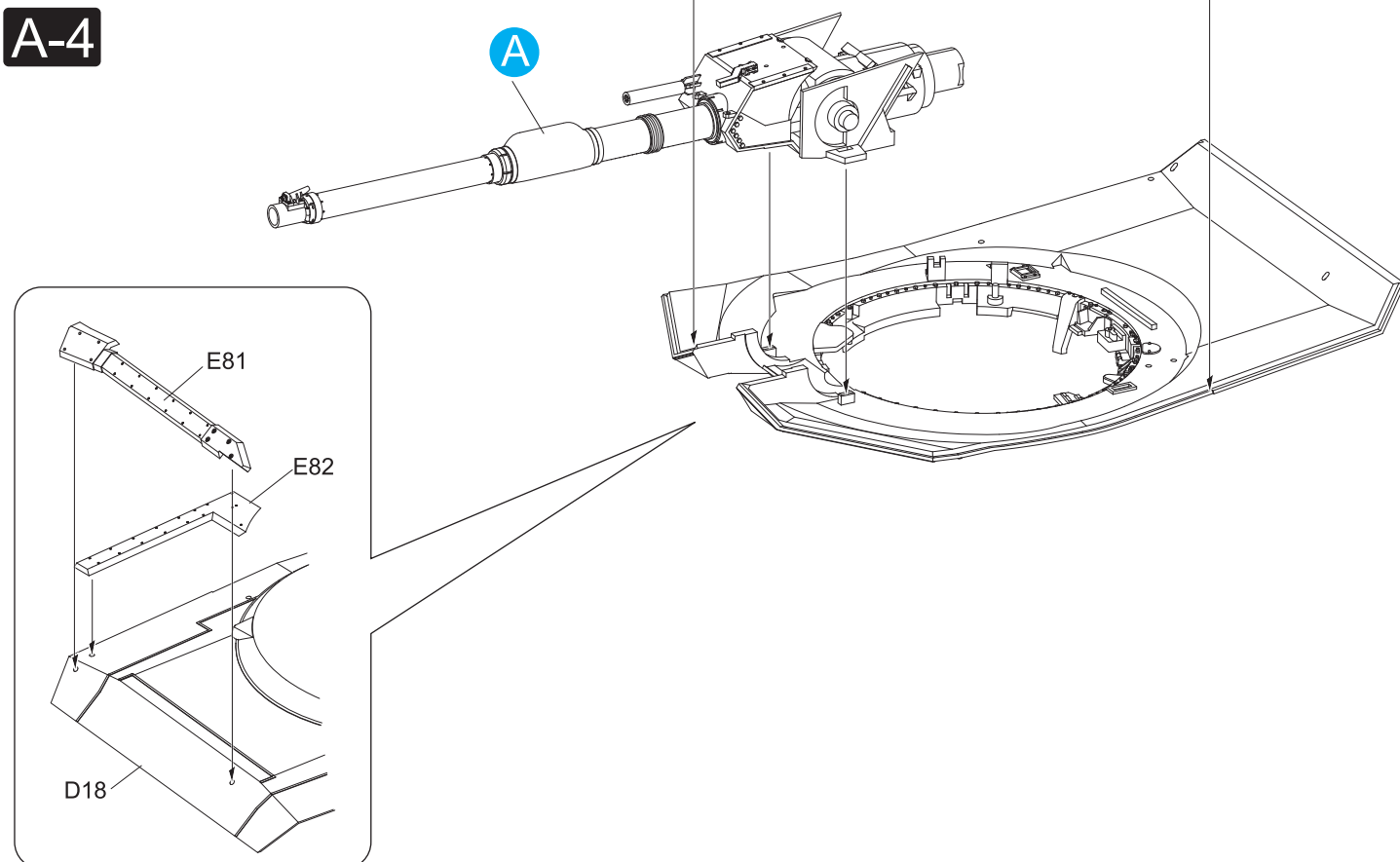

A-5

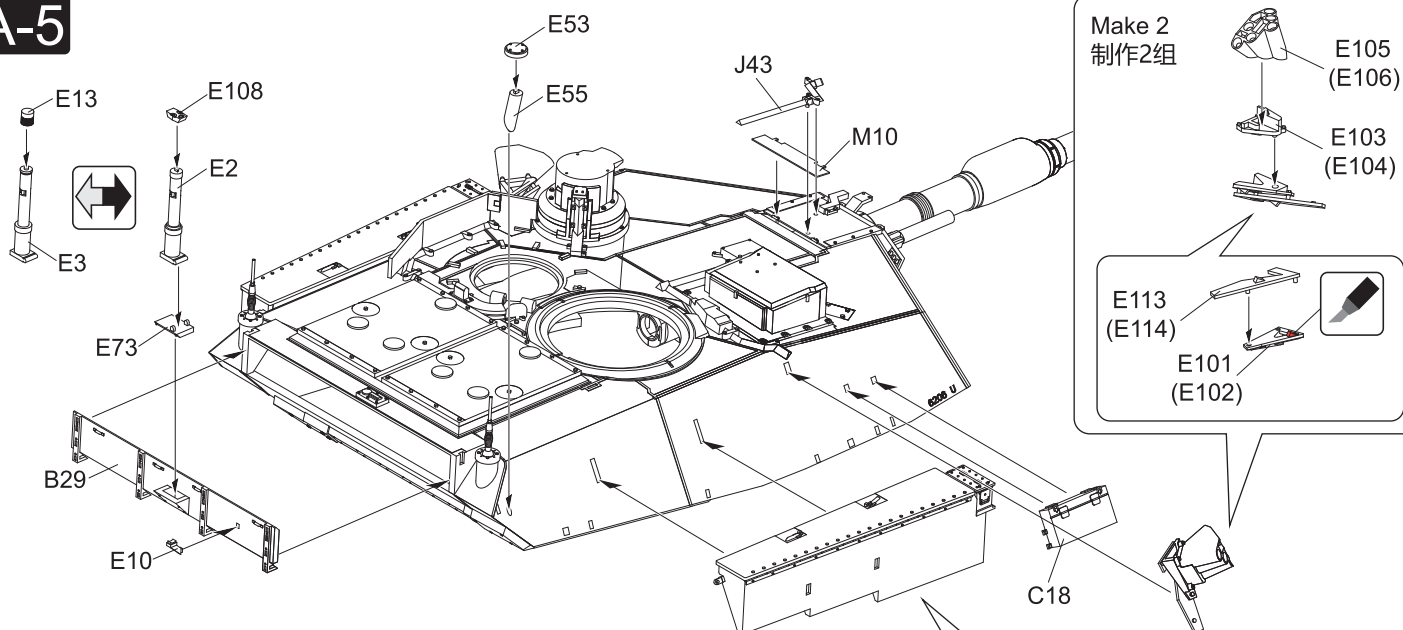
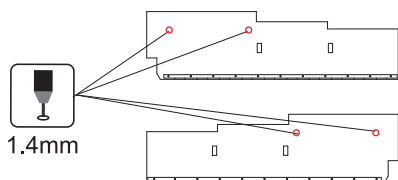
Make 2
制作2组

Open hold when assembly M1A2 TUSK II
组合M1A2 TUSK II时钻孔

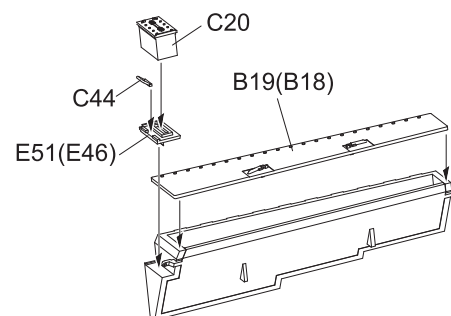
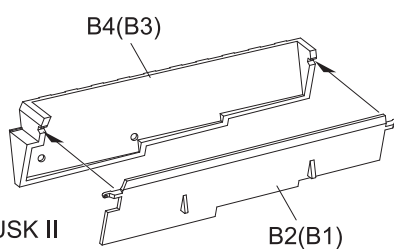

B

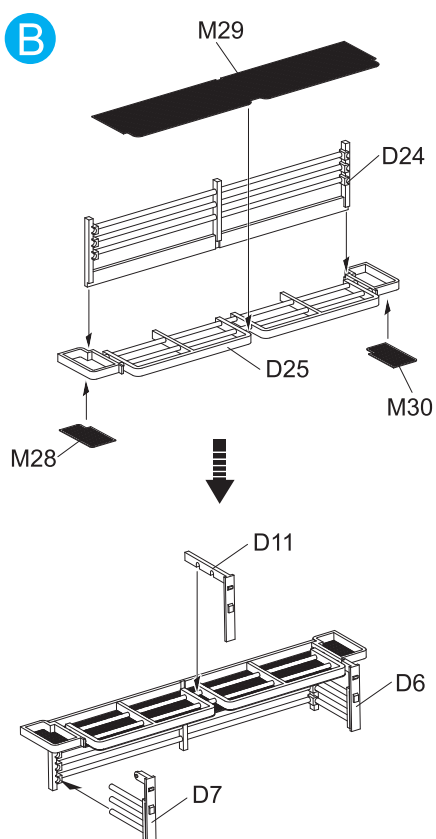

C

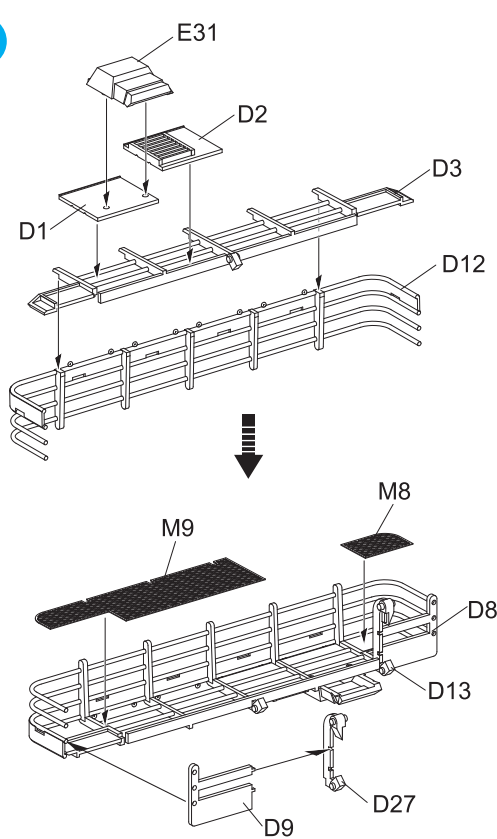

A-6

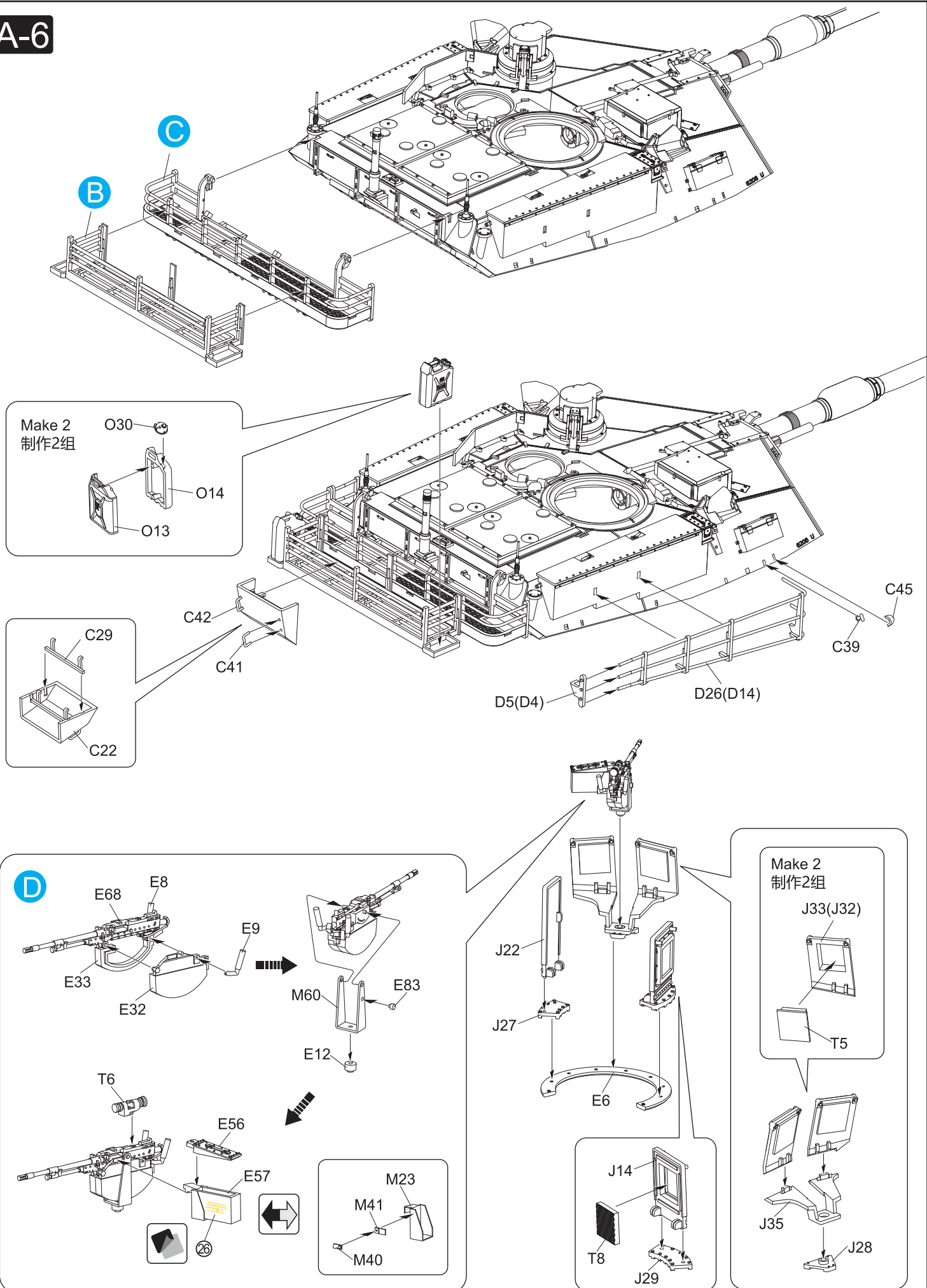

E

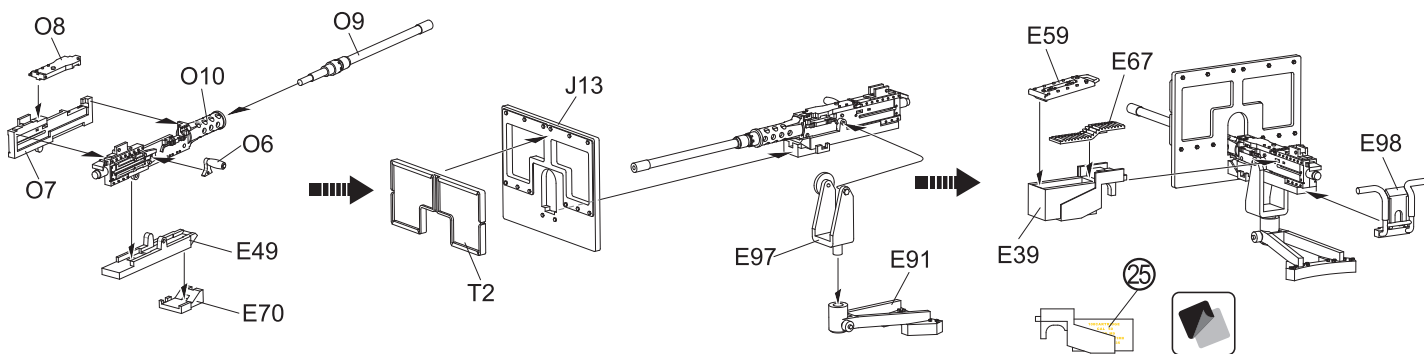
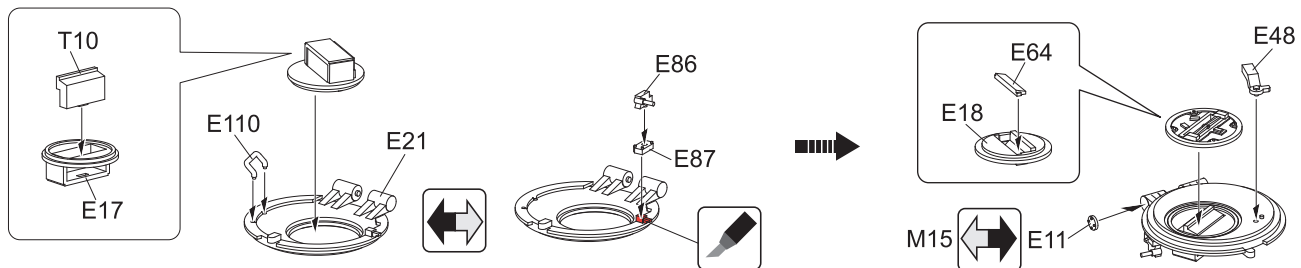

F

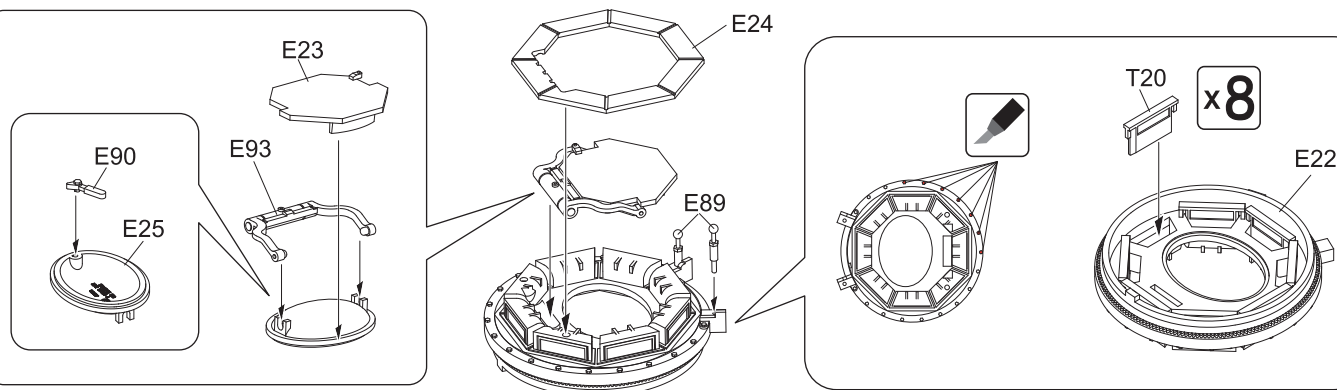
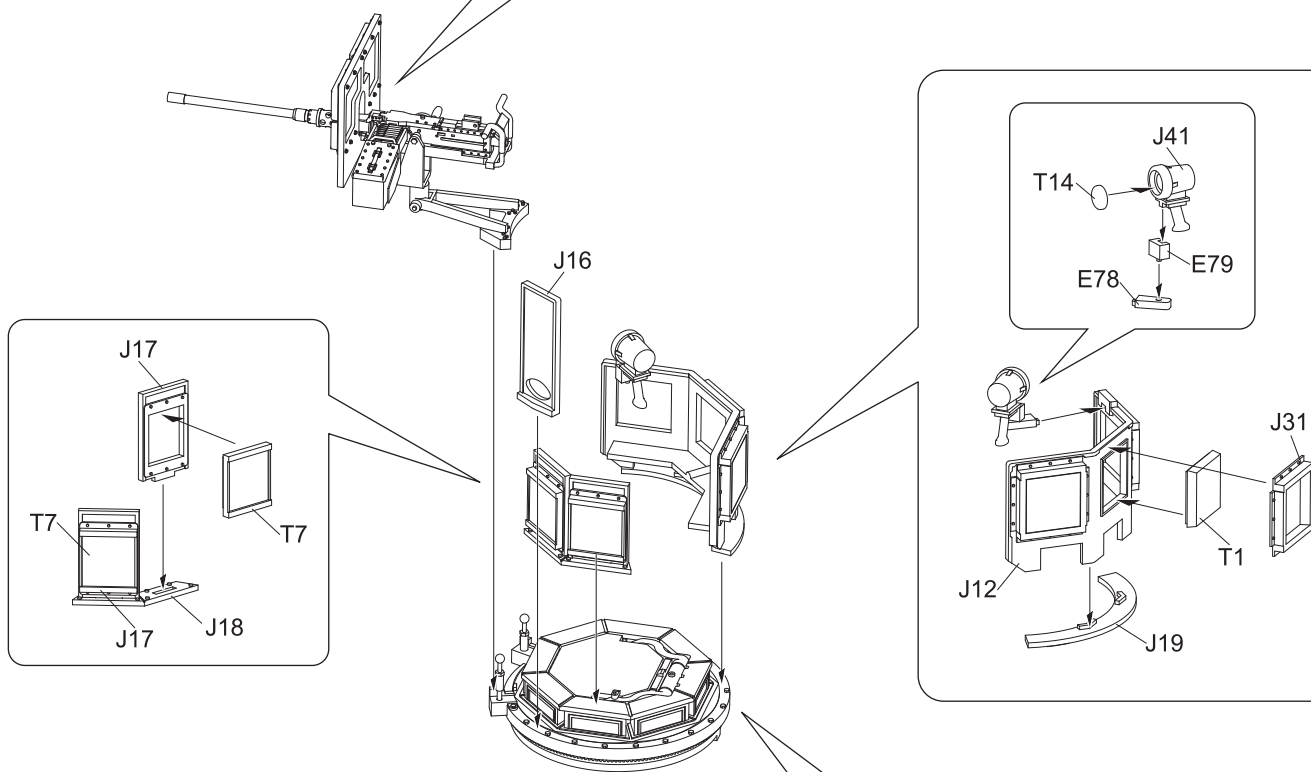

A-7

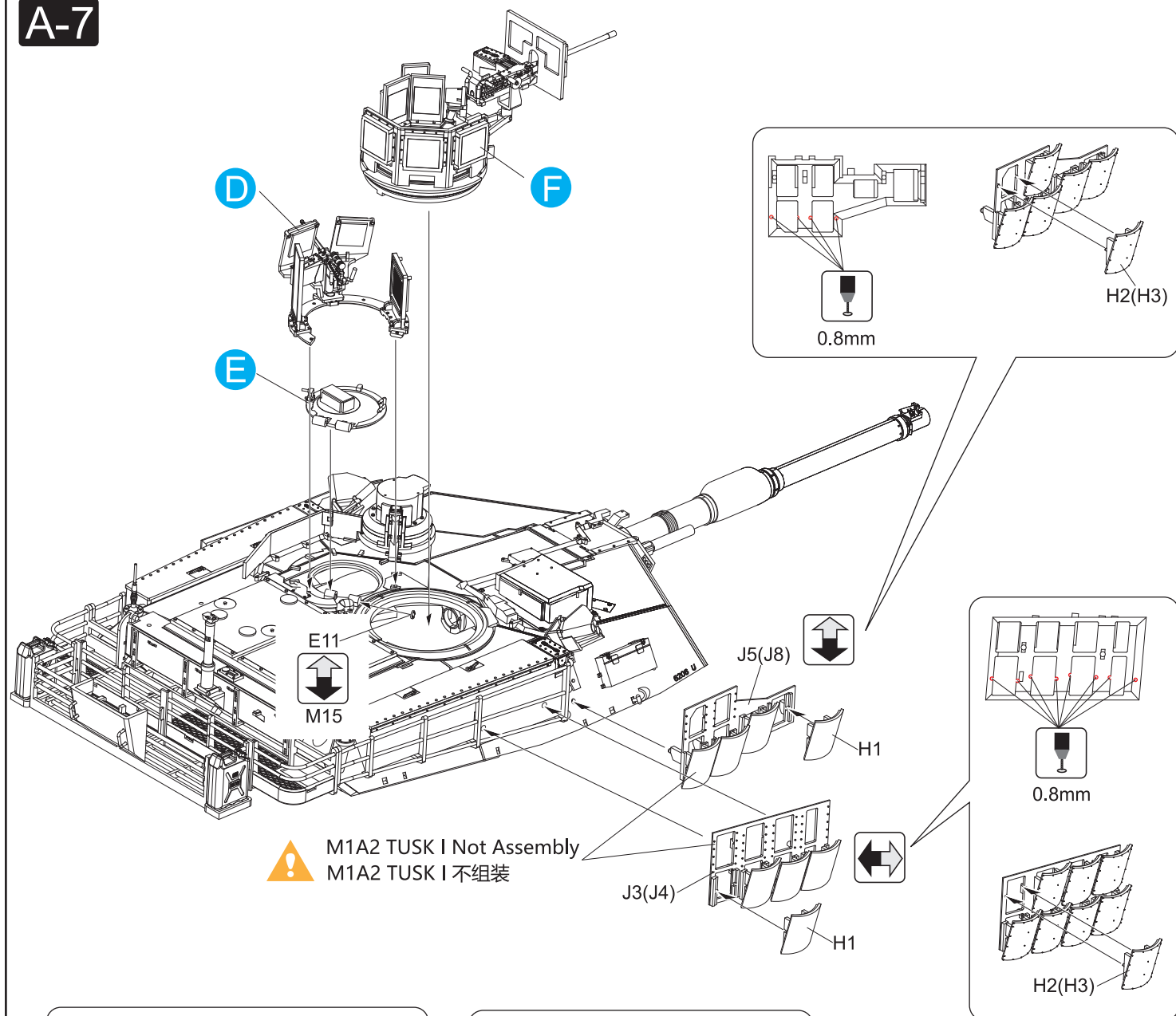

J

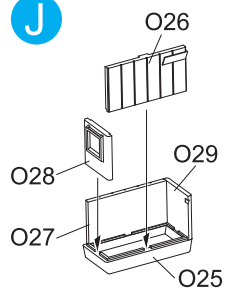

L

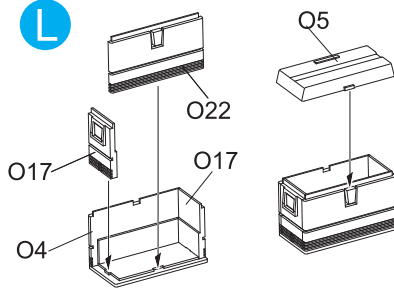

M

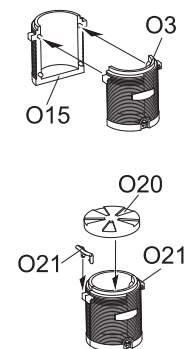

K

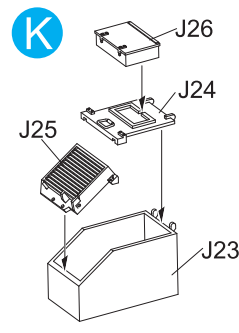

I

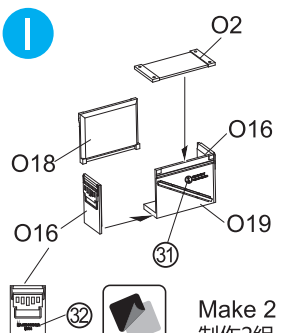

H

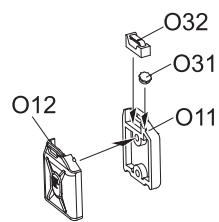
Make 2
制作2组

G

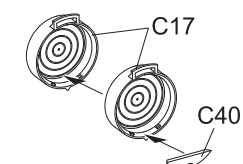

B-1

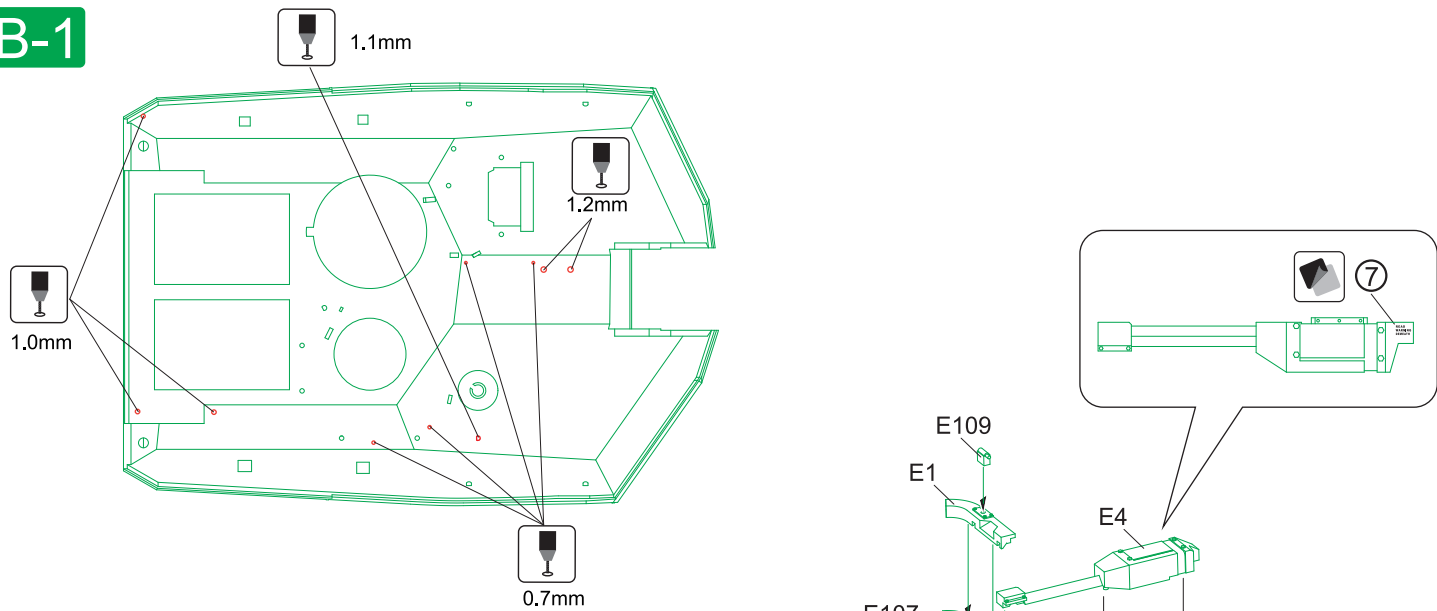

B-2

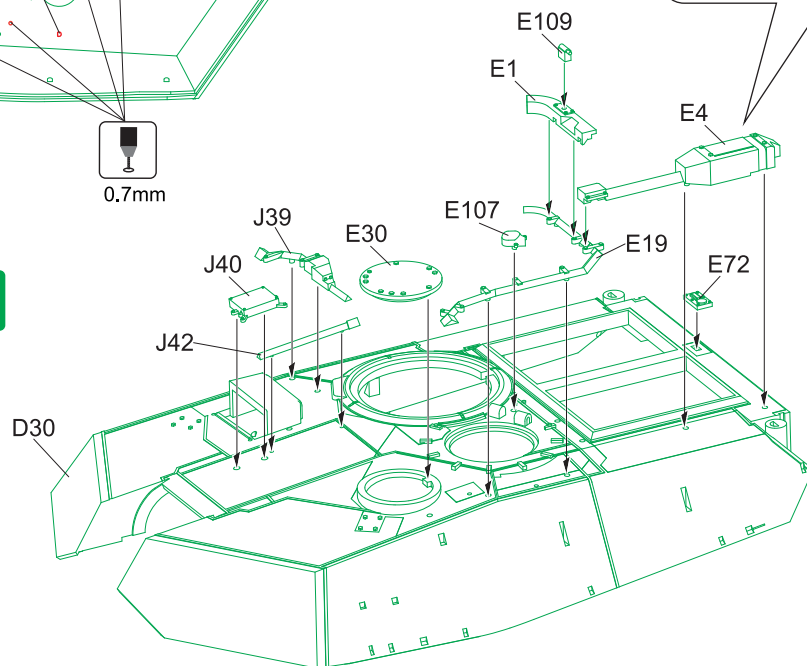

B-3

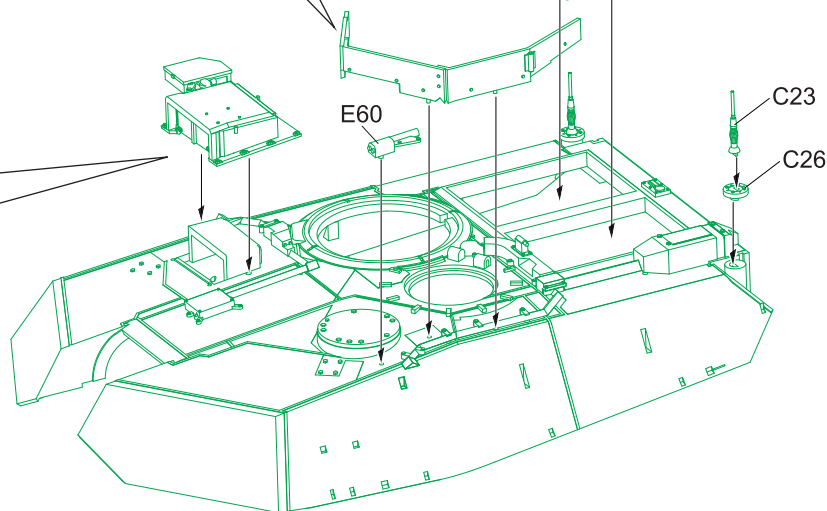
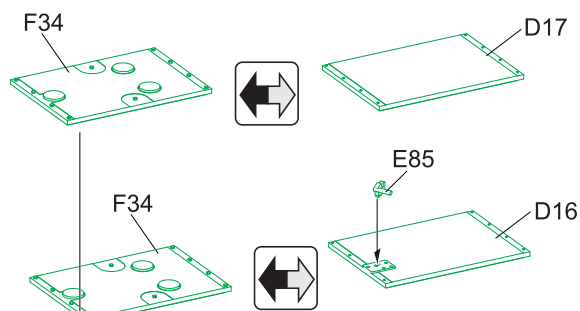
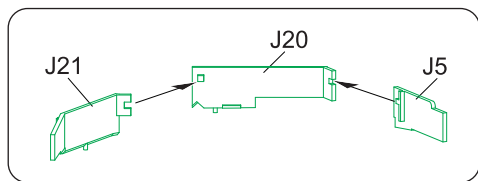
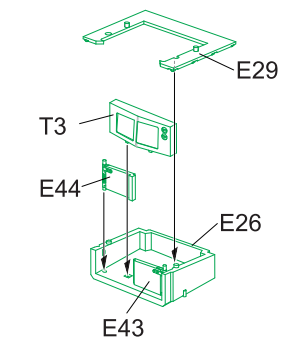

B-4

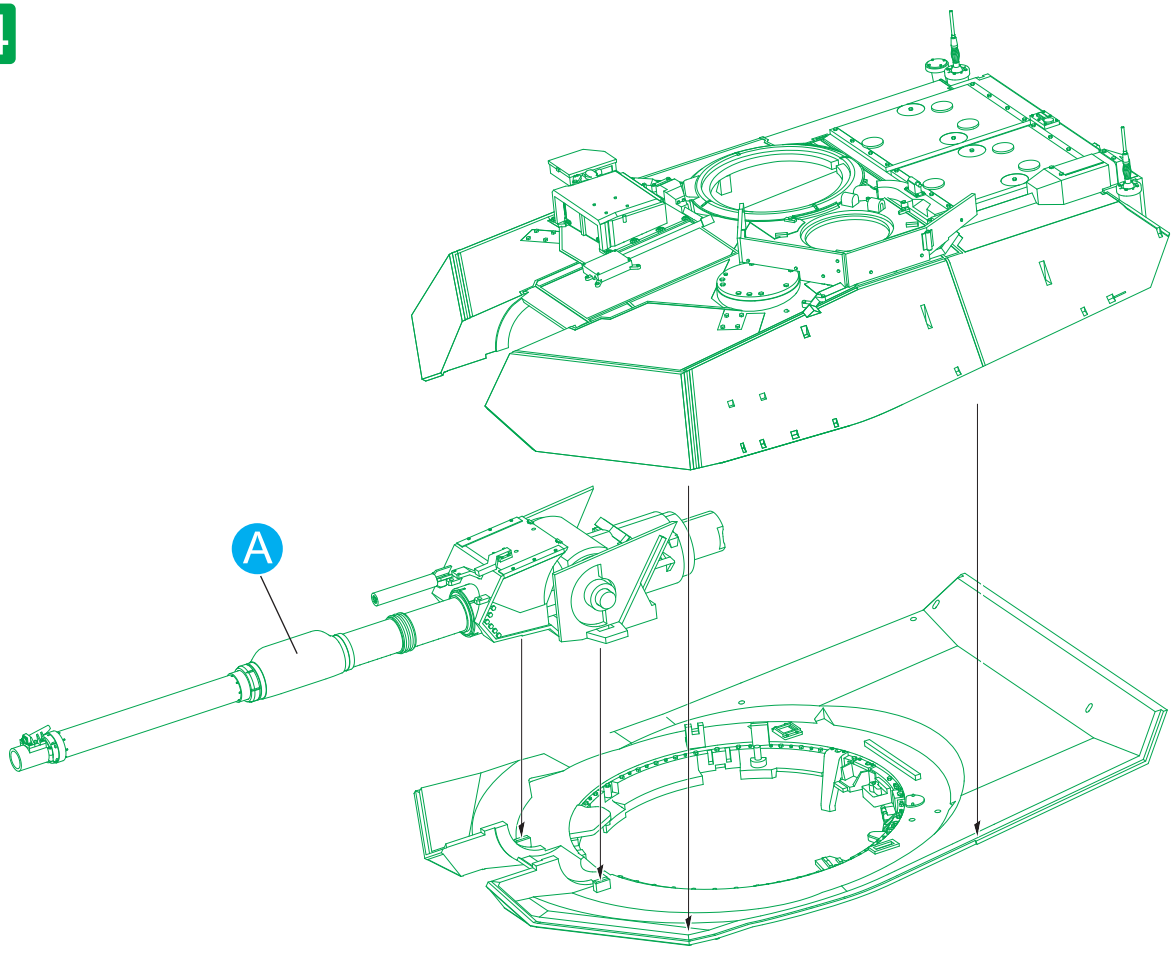

B-5

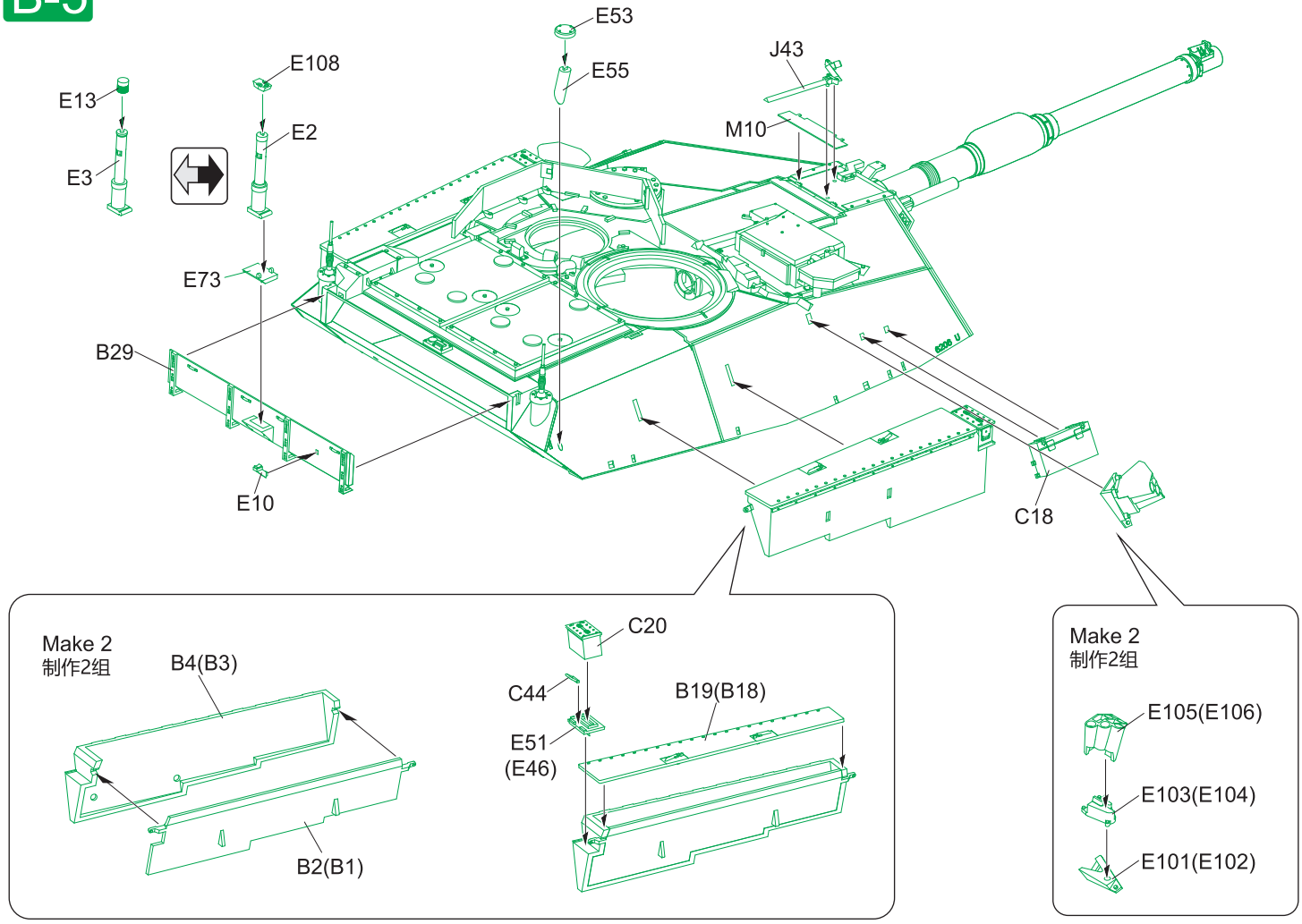

B-6

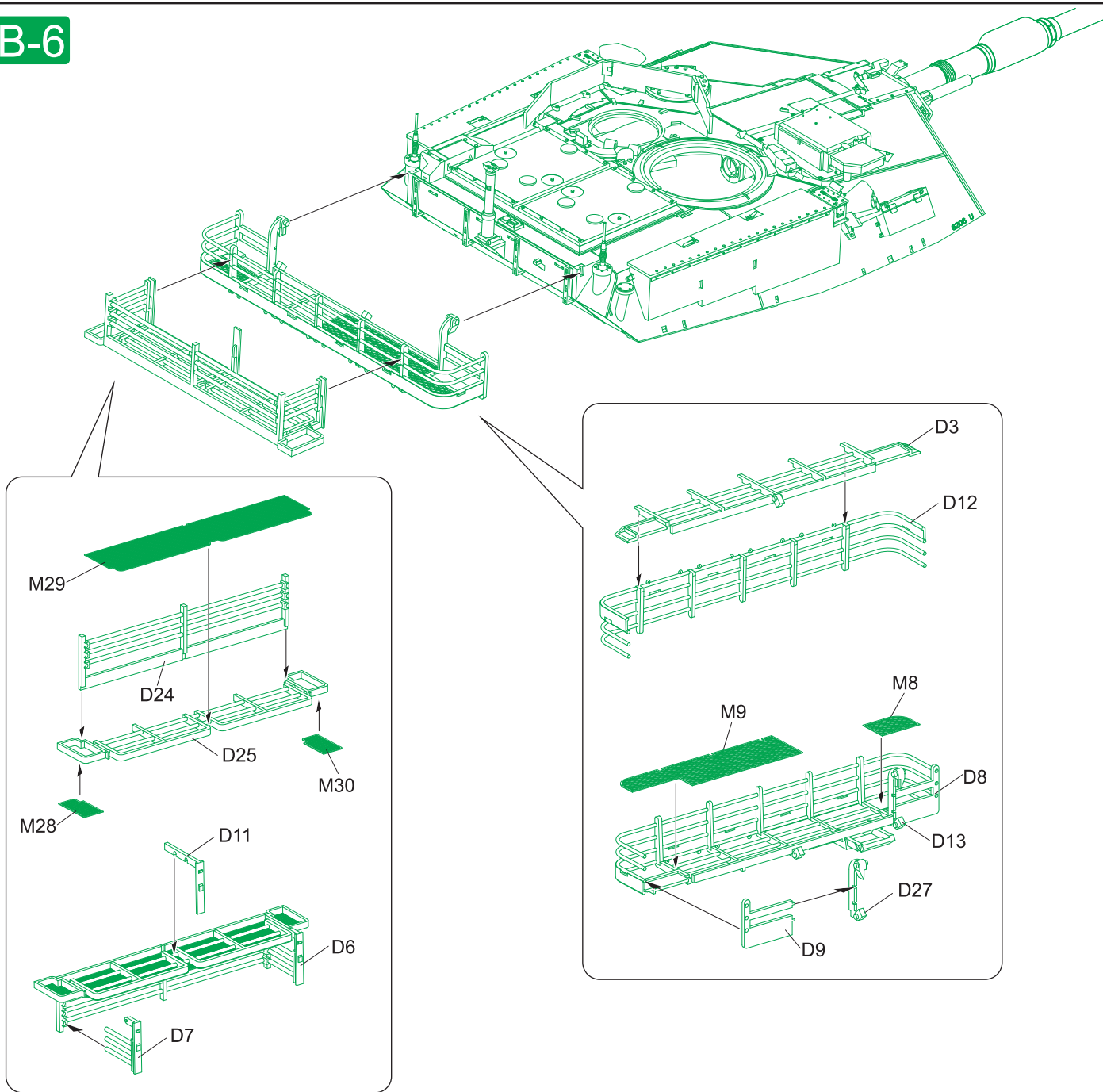

B-7

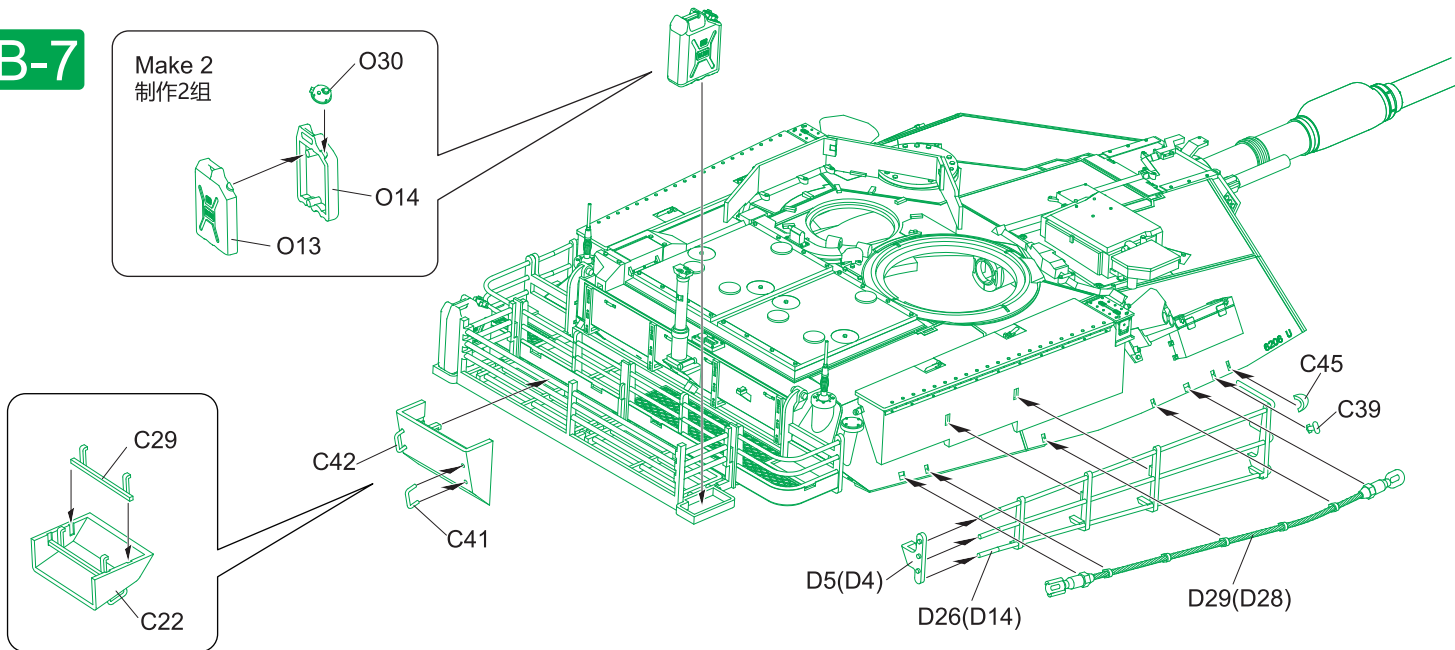

N

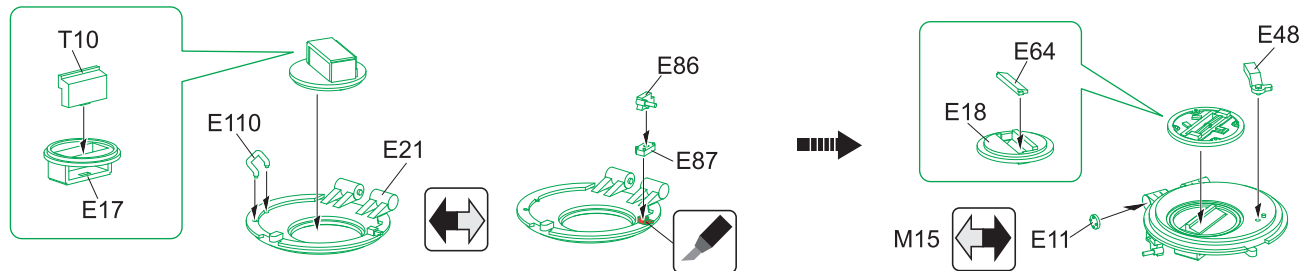

O

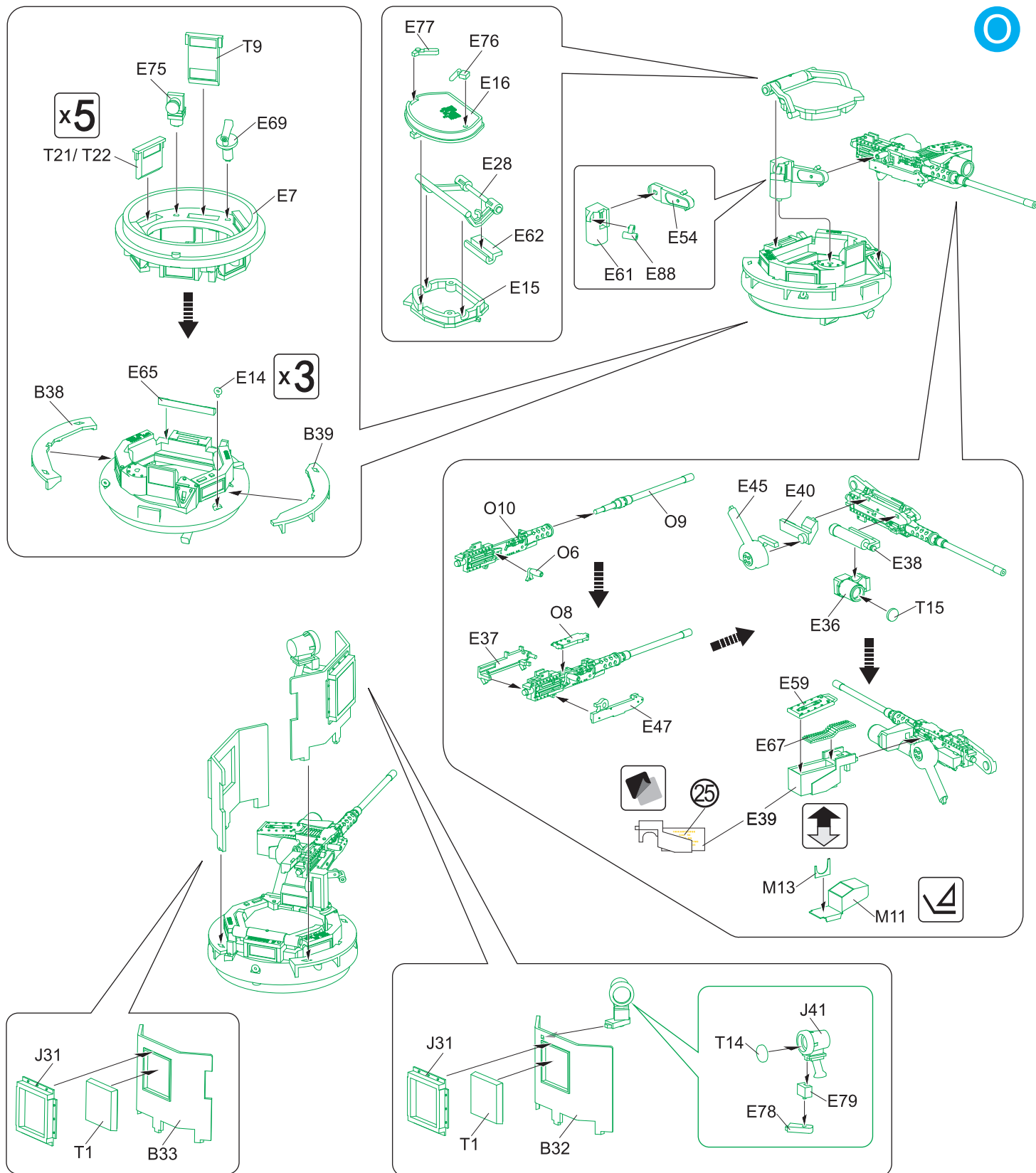

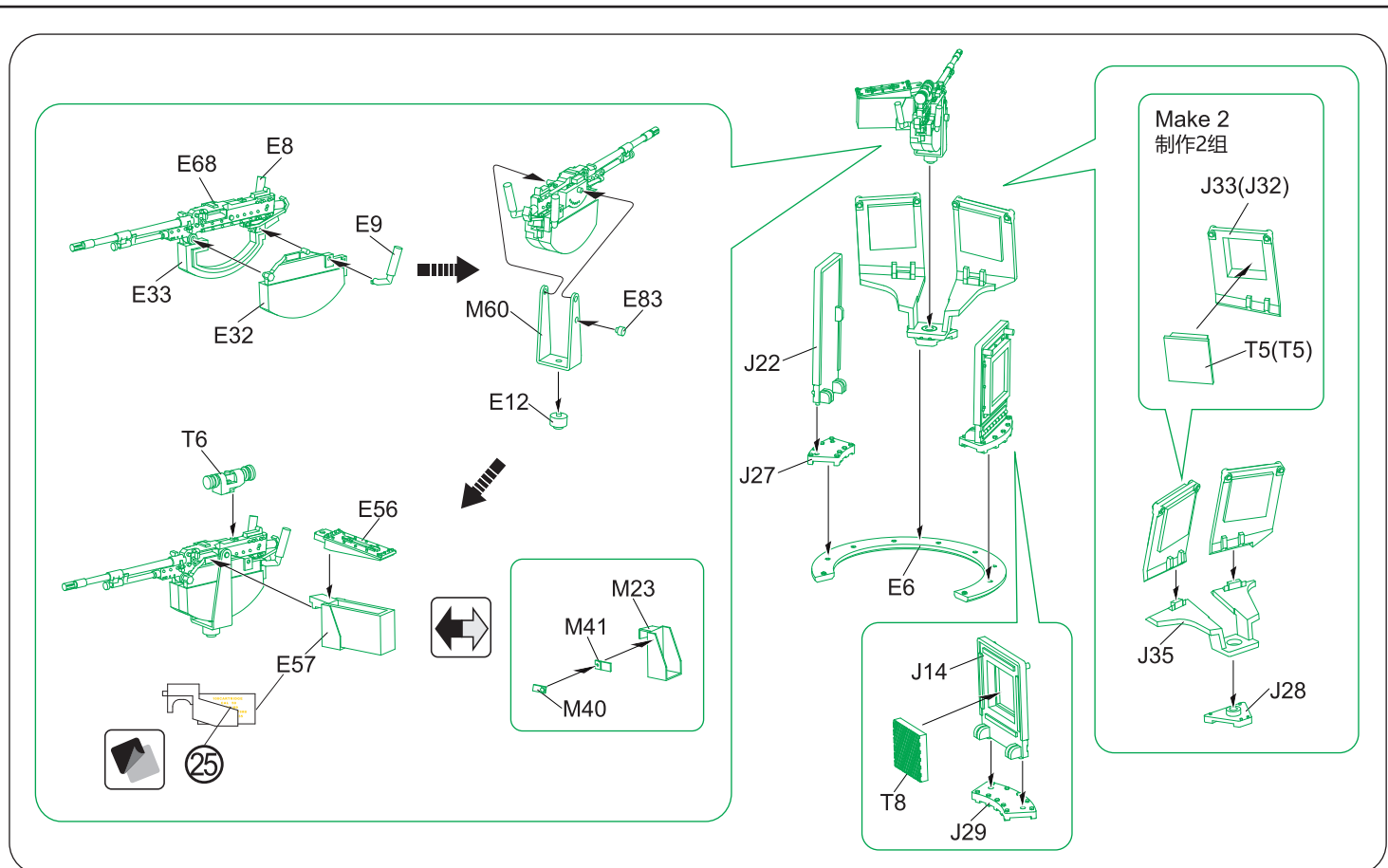

B-8

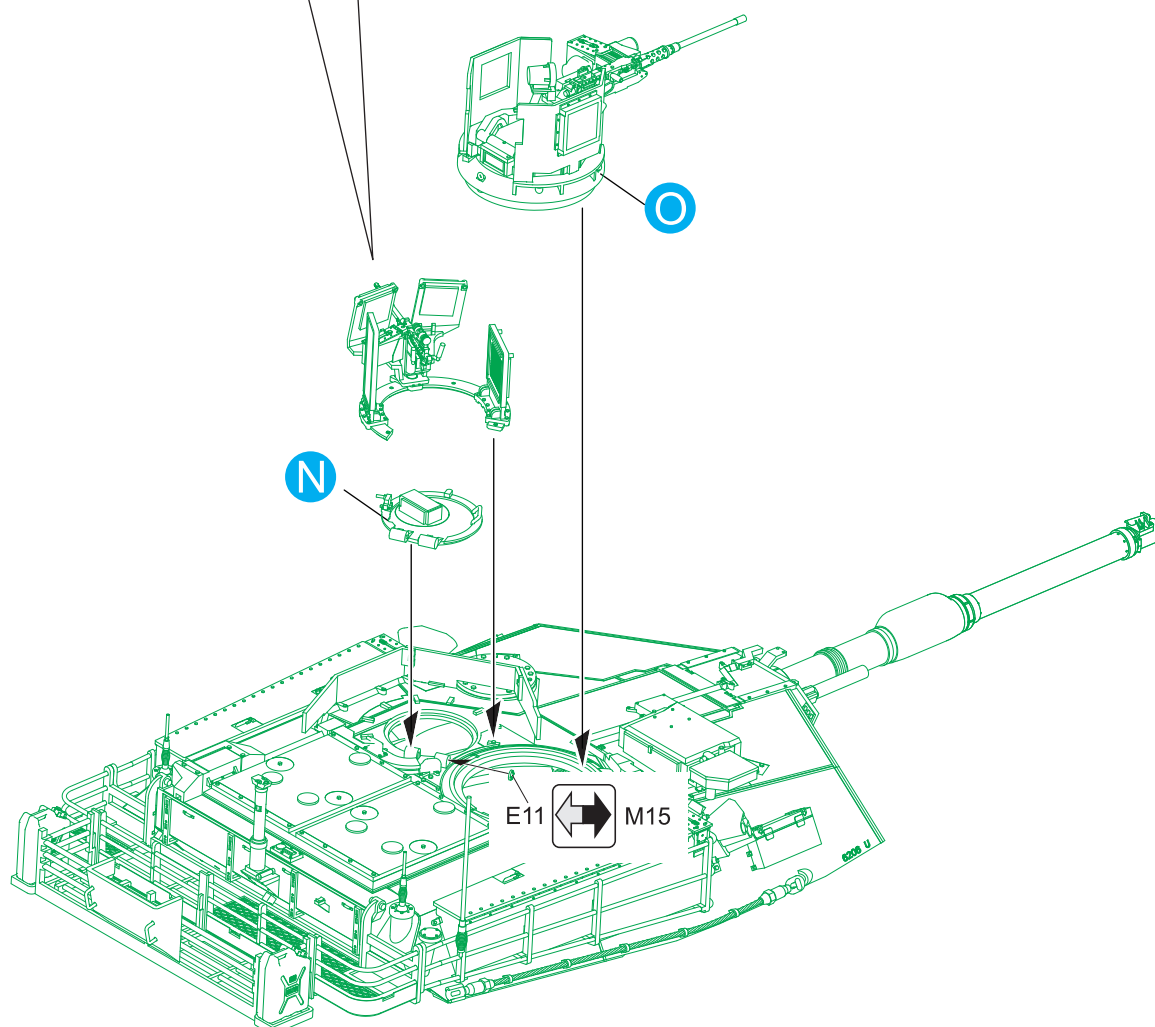

C-1

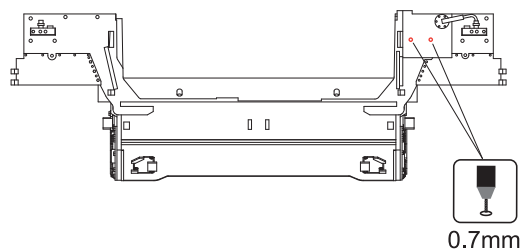
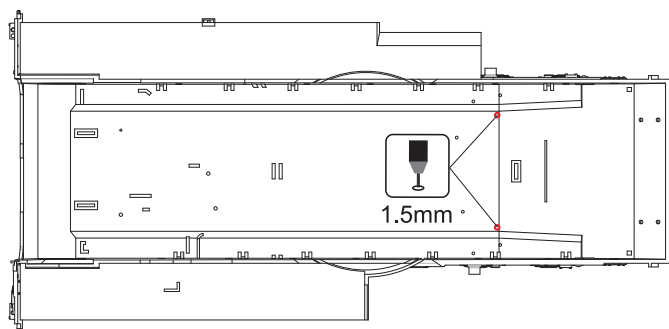

C-2

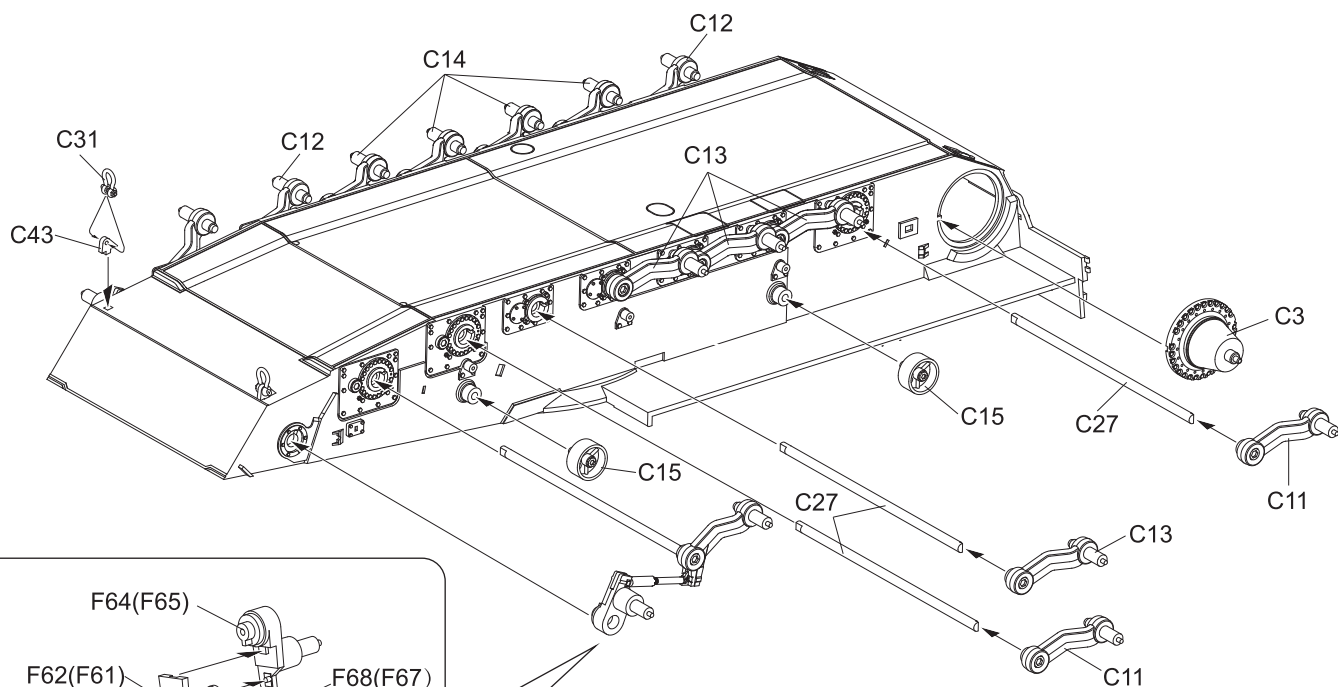

Make 2
制作2组

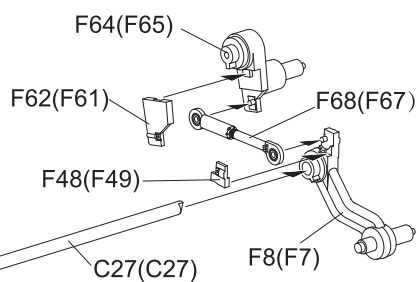

C-3

Applied for M1A1 TUSK
M1A1 TUSK 适用

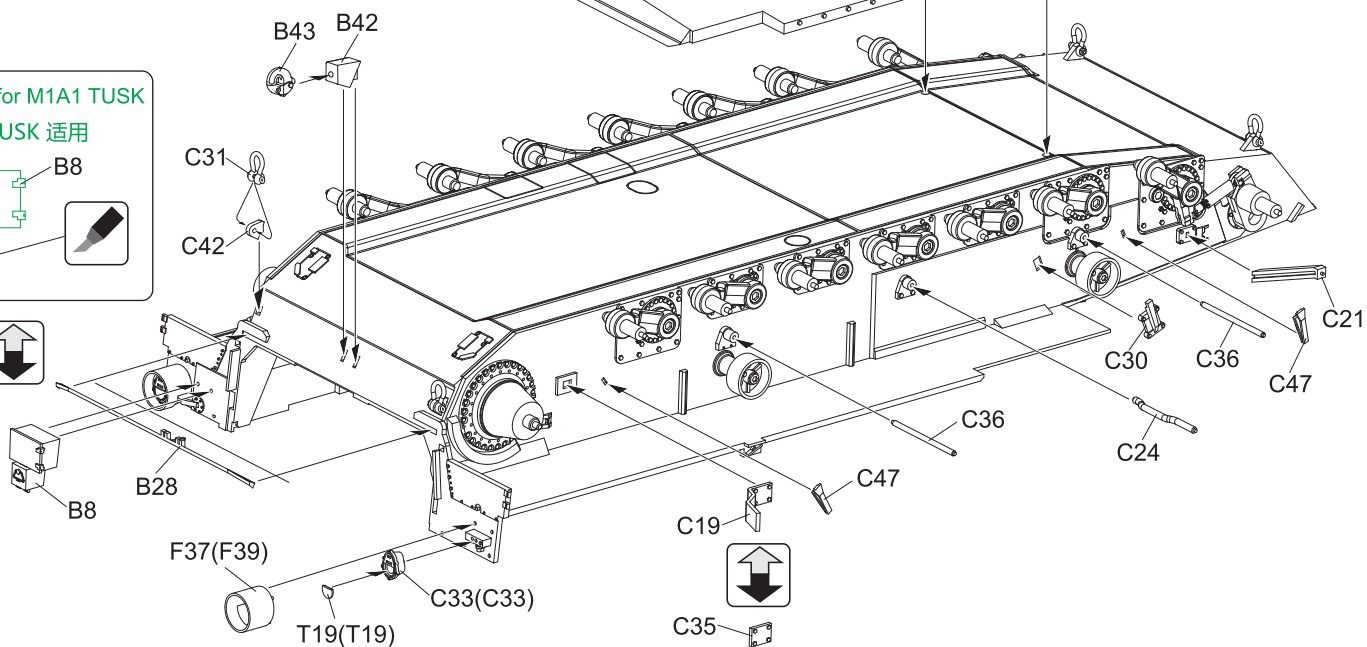
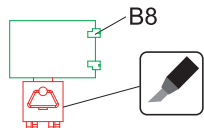

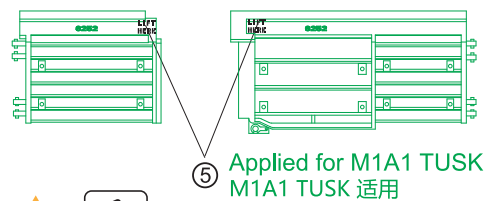
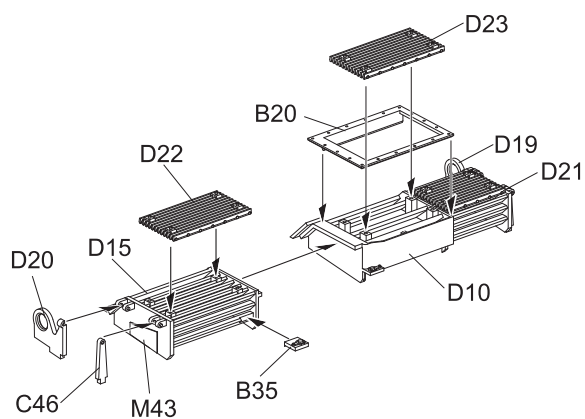

Applied for M1A2 TUSK II and M1A2 TUSK I
M1A2 TUSK II 和 M1A2 TUSK I 适用

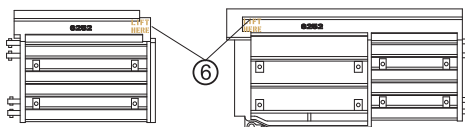

C-4

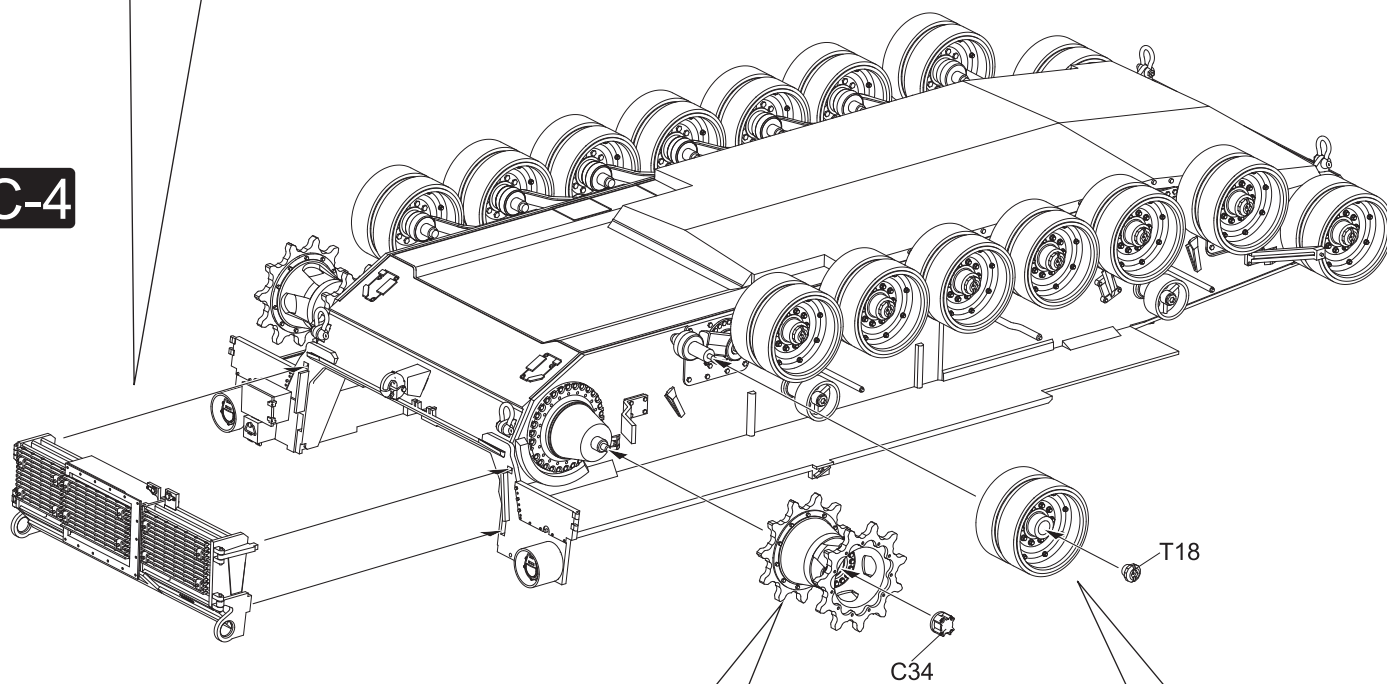

Make 2
制作2组

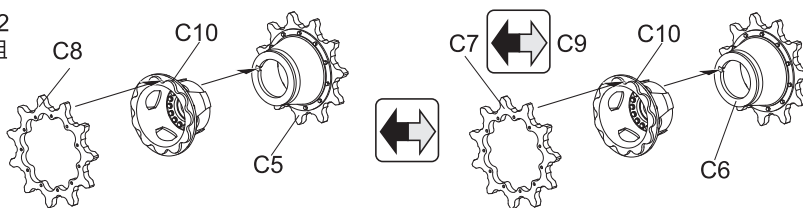

Make 16
制作16组

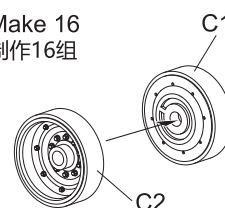

C-5

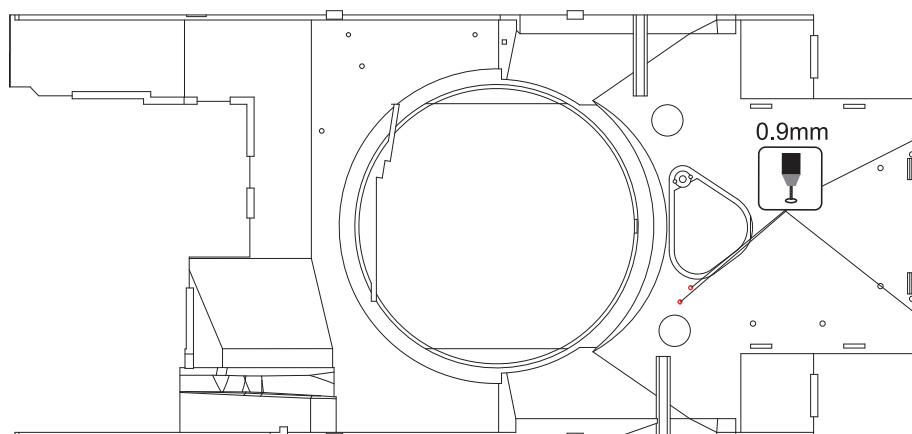

C-6

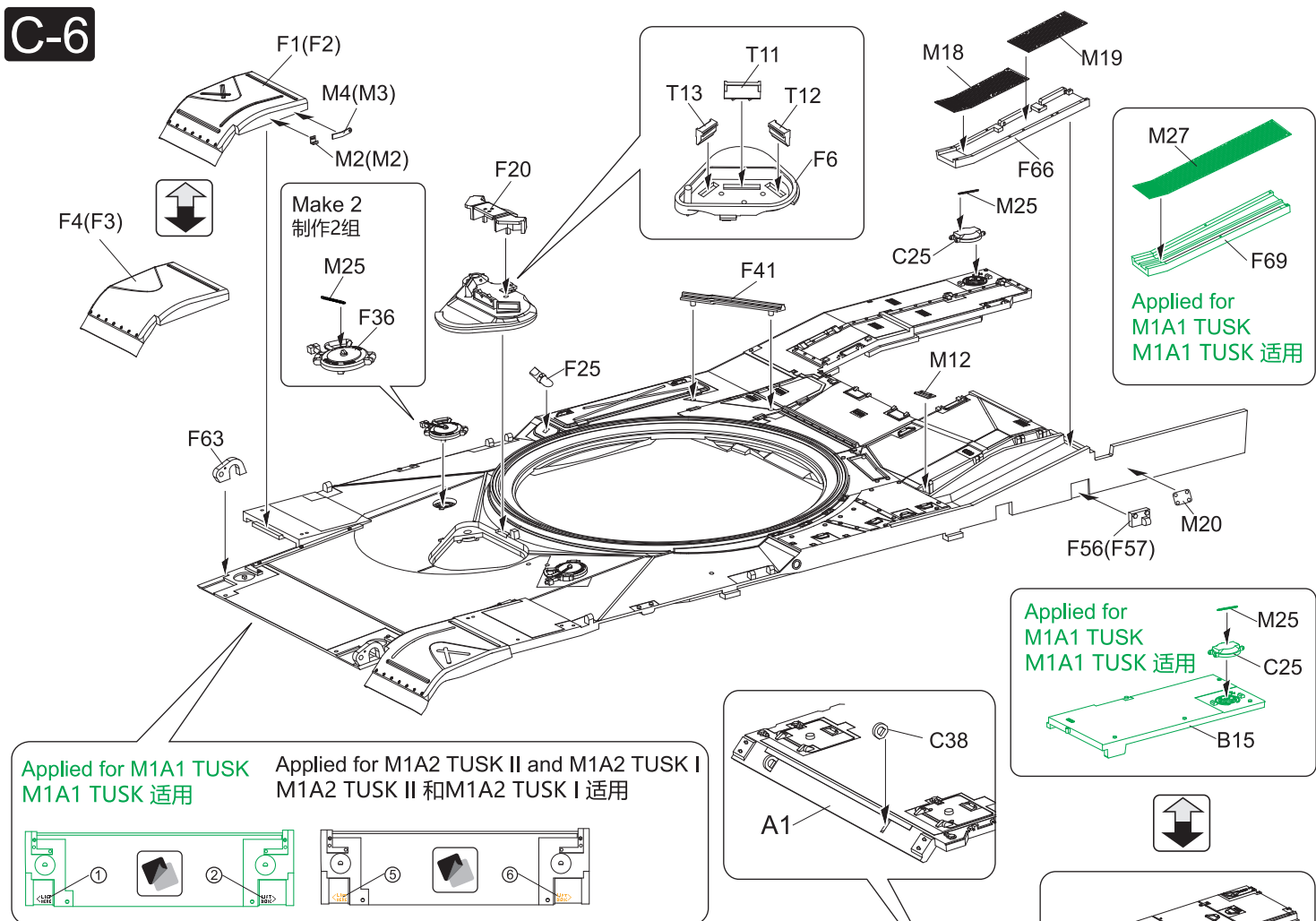

C-7

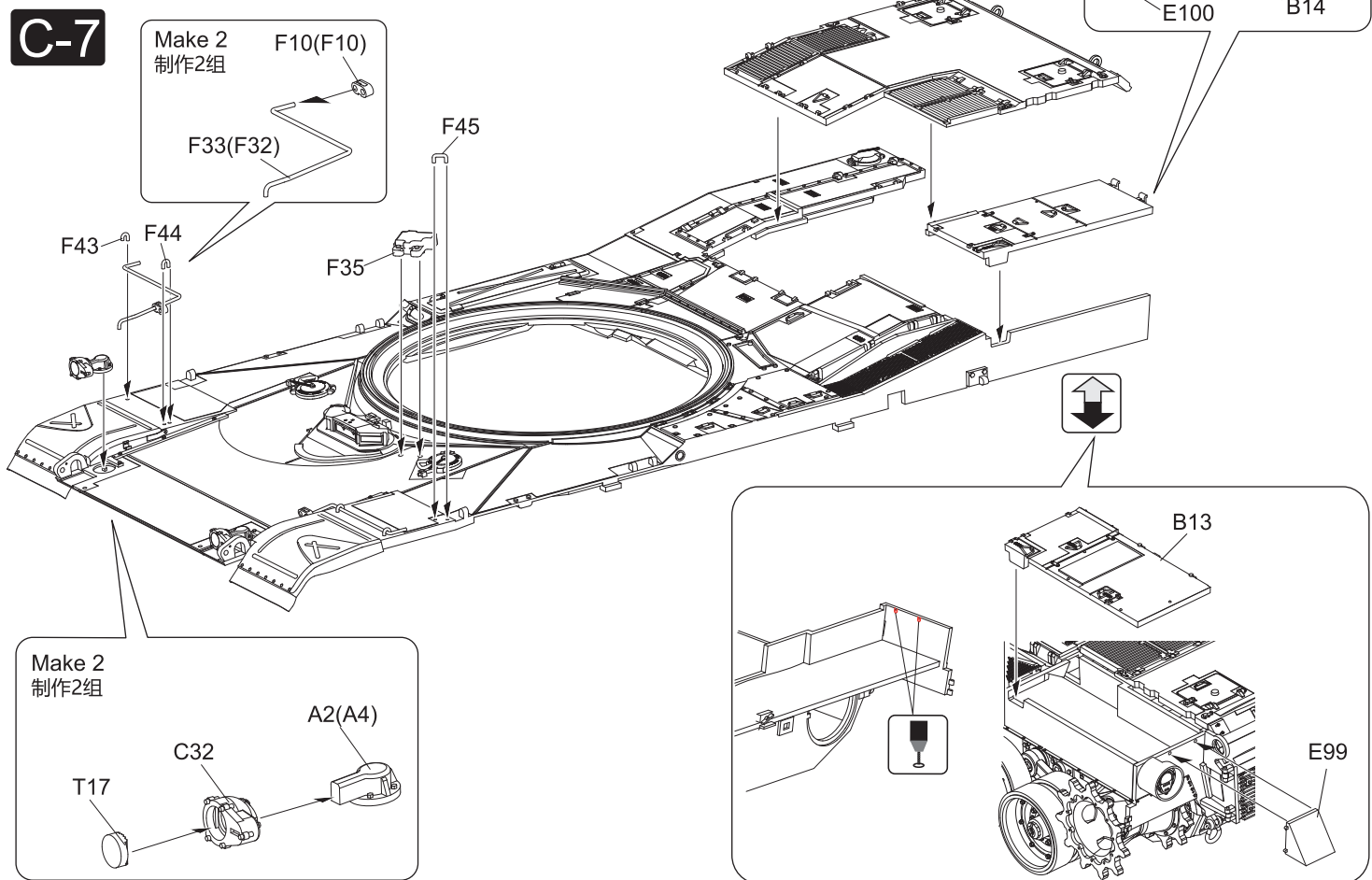

C-8

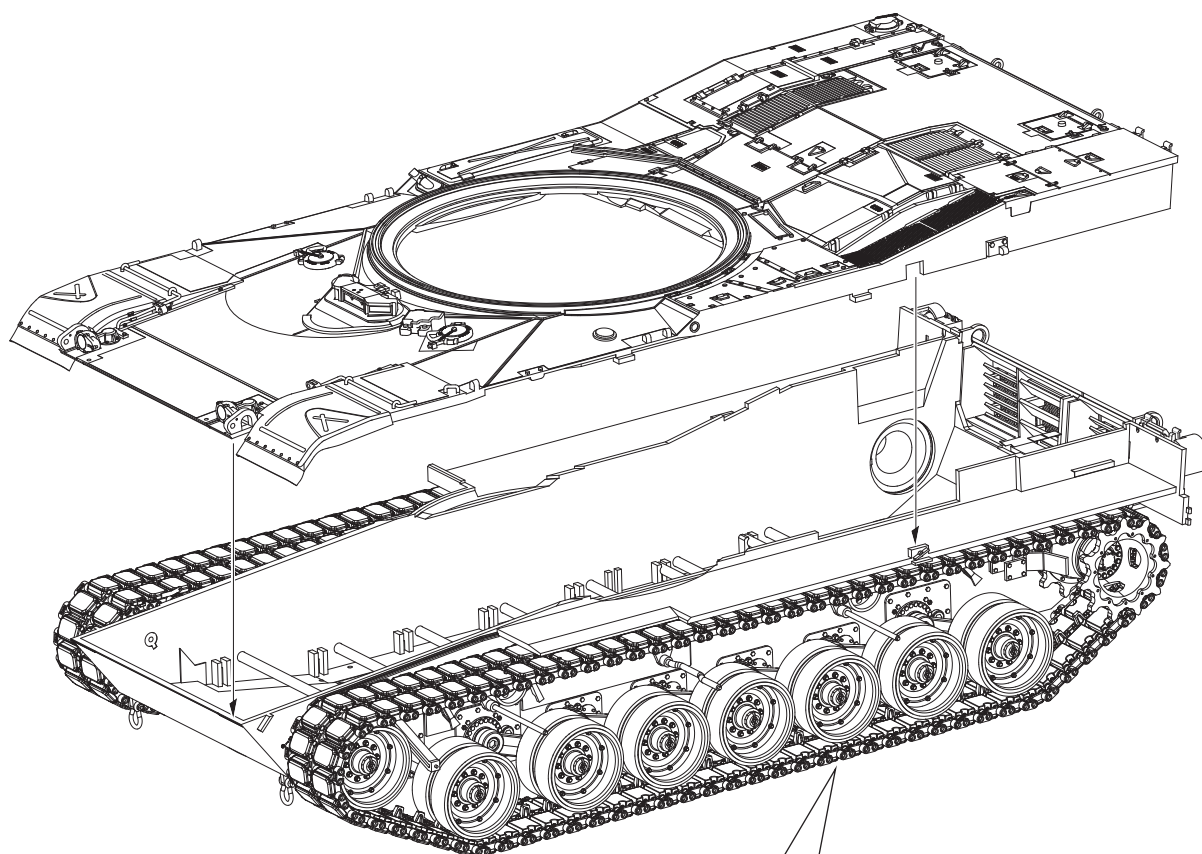

Track Links: 78pcs for each side.

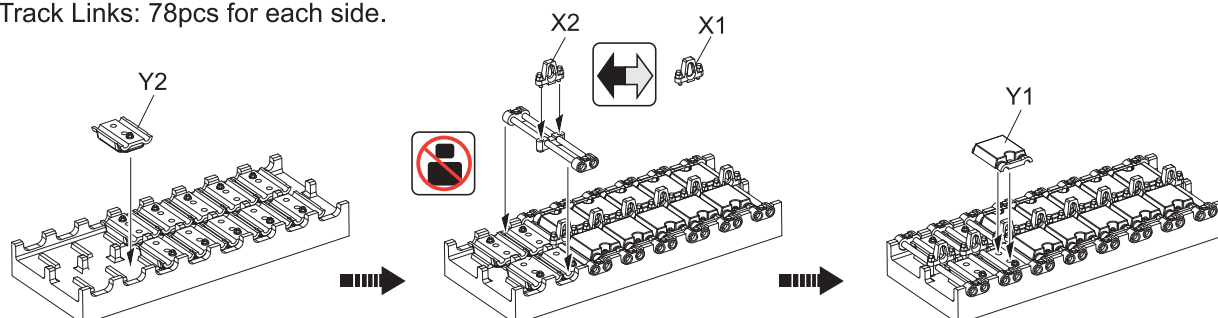

C-9

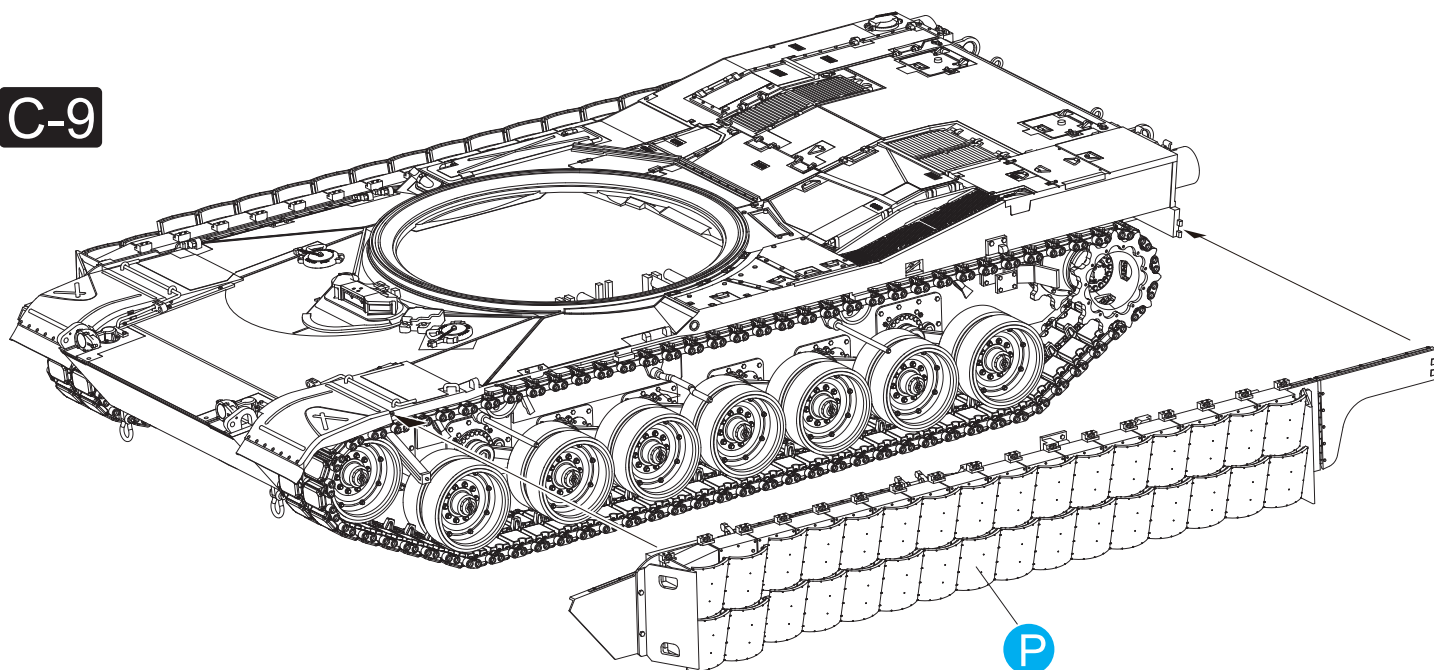

P

Applied for M1A2 TUSK II

M1A2 TUSK II 适用

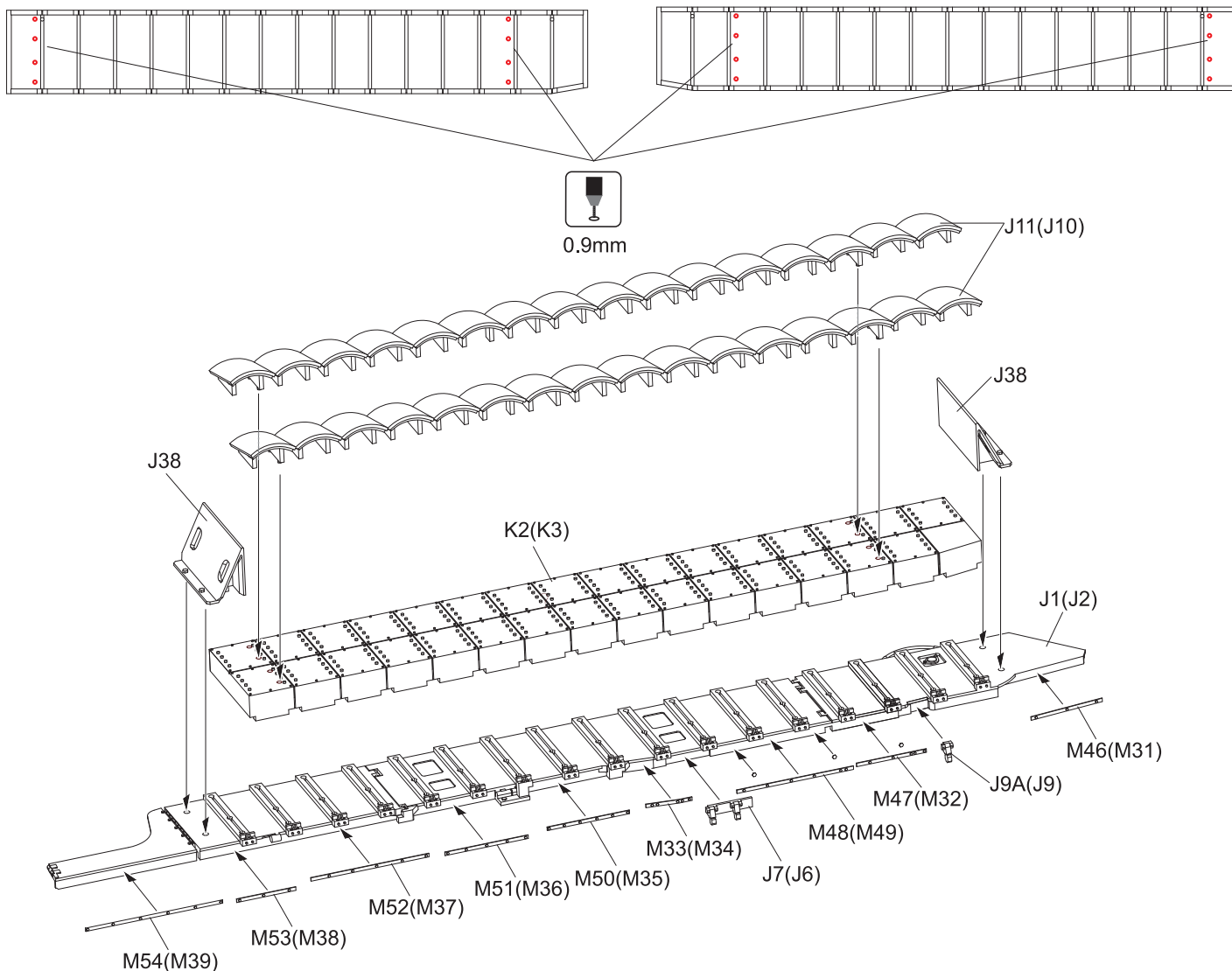
Make 2
制作2组

Applied for M1A1 TUSK

M1A1 TUSK 适用

Make 2
制作2组